

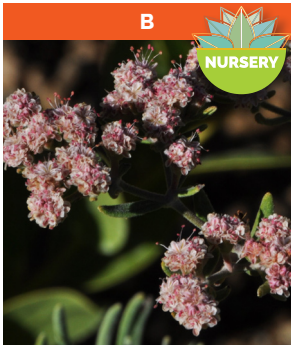

***Epilobium canum***

California Fuchsia  
California native  
Spreading perennial to 1½ ft. tall  
Full sun  
Hardy to mid-teens F



***Eriogonum arborescens***

California native  
Shrub to 3 – 4 ft. tall  
Full sun  
Hardy to upper teens F



***Calliandra 'Sierra Starr'***

Hybrid; parents native to SW USA & Mexico  
Small shrub 4 ft. tall  
Full sun  
Hardy to 15° F

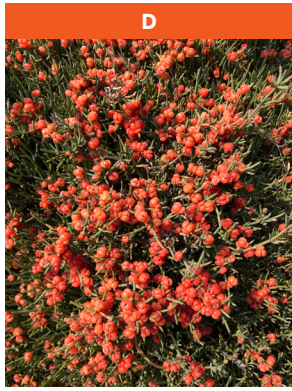

***Ephedra americana var. andina - fruit***

Native to Central Asia  
Shrub to 1ft  
Full sun  
Hardy to 0° F



***Sphaeralcea cv.***

Hybrid; parents from SW U.S.  
Small shrub to 4 ft. tall  
Full sun  
Hardy to teens



***Xanthorrhoea quadrangulata***

Native to Australia  
Grass-like head of lvs. to 4 ft. θ  
Hardy to low 20's

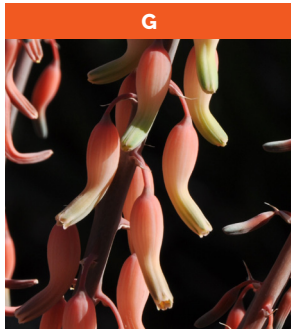

***Gasteria excelsa***

Native to South Africa  
Single stemless rosette to 2½ ft. θ  
Shade to part sun  
Hardy to mid-20's



***Bouteloua gracilis 'Blonde Ambition'***

Native to western North America  
Clumping grass to 2ft. tall  
Full sun to half sun  
Hardy to below 0° F



***Dasylirion wheeleri - female***

Native to southwestern U.S. & northern Mexico  
Rosettes to 6' θ  
Full sun to partial shade  
Hardy to 0° F

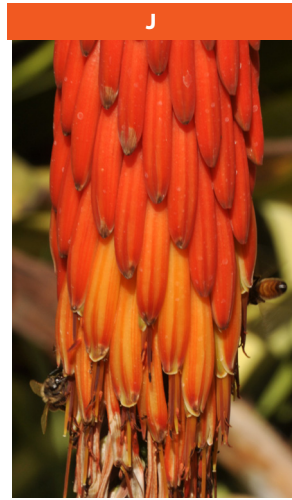

***Aloe reitzii***

Native to northeastern South Africa  
Stemless single rosettes to 4 ft. θ  
Full sun to partial shade  
Hardy to mid-20's F



***Aloe maculata hybrid***

Hybrid; full parentage unknown  
Stemless clumper  
Full sun to partial shade  
Hardy to 20° F



***Euphorbia echinus***

Native to Morocco  
Tight clump to 3 ft. θ  
Full sun  
Hardy to 20° F

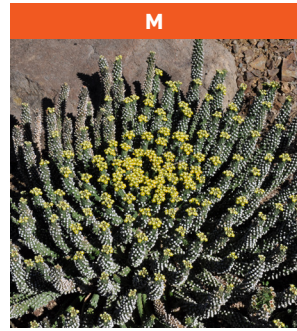

***Euphorbia inermis var. huttoniae***

Native to South Africa  
Stemless "medusoid" euphorbia to 1½ ft. θ (central head & snake-like arms)  
Full sun  
Hardy to upper teens



***Erythrina x bidwillii***

Hybrid (1 parent S. American, 1 N. American)  
Deciduous shrub to 8 ft. tall  
Full sun  
Hardy to 20° F

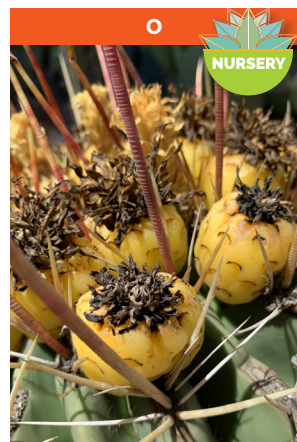

***Ferocactus emoryi ssp. rectispinus - fruit***

Native to Baja California  
Barrel cactus to 1½ ft. θ  
Full sun  
Hardy to mid-20's F





P

*Opuntia robusta* – fruit

Native to Mexico  
Large prickly-pear to 12' tall  
Full sun  
Hardy to teens



S

NURSERY

*Grevillea 'Kings Fire'*

Hybrid; parents from Australia  
Shrub to 5-6 ft. tall  
Full sun  
Hardy to 25° F

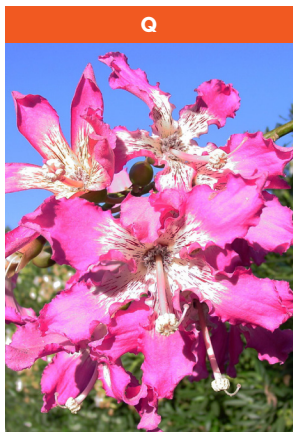

Q

*Ceiba speciosa*

(*Chorisia speciosa*; silk-floss tree)  
Native to South America  
Tree to 50 ft.  
Full sun  
Hardy to low 20's



T

*Echeveria gigantea*

Native to Mexico  
Stem-forming, single; to 2 ft. tall  
Partial shade  
Hardy to upper 20's



R

*Salvia azurea* var. *grandiflora*

Native to central U.S.  
Sprawling herbaceous plant to 3' tall  
Full sun  
Hardy to 15° F



U

*Aloe (labworana x hildebrandtii)*

Hybrid; parents from Uganda & Somalia  
Clumping; rosettes to 3 ft. Ø  
Full sun to partial shade

The Ruth Bancroft Garden and Nursery Map

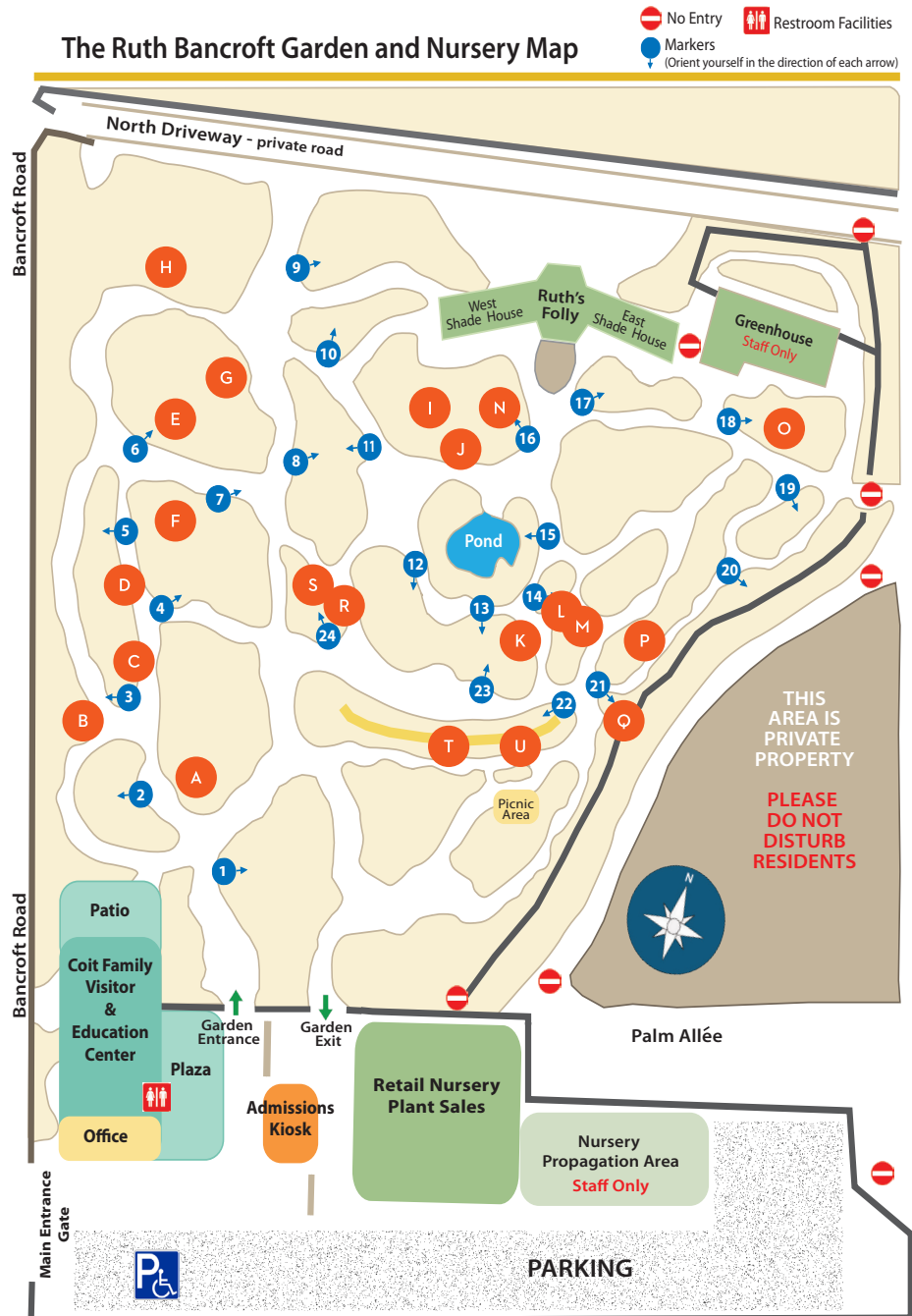

WHAT'S IN BLOOM  
Information Key



This plant or a similar variety is available for purchase in our nursery



indicates diameter