



***Yucca rostrata***  
Native to northern Mexico & western Texas  
Tree-like to 15' tall, sparingly branched  
Full sun  
Hardy to 10° F



***Alyogyne 'Ruth Bancroft'***  
Hybrid, with both parents from Australia  
Shrub to 8 ft. tall  
Full sun  
Hardy to mid-20's



***Eriogonum latifolium***  
California Channel Islands native  
Perennial clumper to 8" tall  
Full sun  
Hardy to upper teens

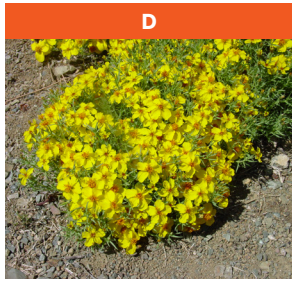

***Zinnia grandiflora***  
Native to western U.S. & northern Mexico  
Subshrub less than a foot tall  
Full sun  
Hardy to below 0° F

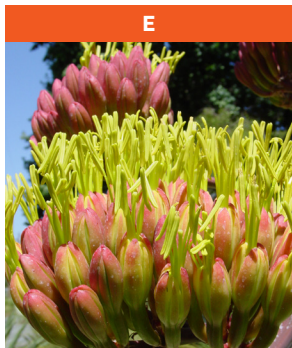

***Agave parrasana***  
Native to northern Mexico  
Rosettes to 2 ft. Ø  
Full sun to partial shade  
Hardy to low 20's F

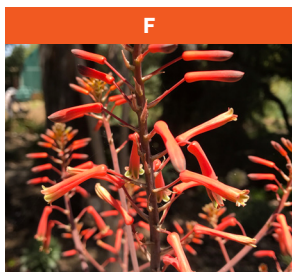

***Aloe kouebokkeveldensis***  
Native to western South Africa  
Solitary stemless rosettes to 4 ft. Ø  
Full sun to partial shade  
Hardy to 25° F



***Albuca nelsonii***  
Native to South Africa  
Clump-forming, to 3-4' tall  
Partial shade  
Hardy to mid-20's



***Senecio viravira***  
Native to Argentina  
Perennial to 16 in. tall  
Full sun to partial shade  
Hardy to 15° F



***Aloe striatula***  
Native to South Africa & Lesotho  
Shrub to 5-6' tall  
Full sun to partial shade  
Hardy to upper teens



***Dyckia encholirioides***  
Native to southern Brazil  
Clumper with rosettes to 2 ft. Ø  
Full sun to partial shade  
Hardy to low 20's

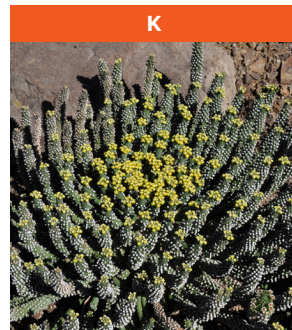

***Euphorbia inermis v. huttonae***  
Native to South Africa  
Stemless "medusoid" euphorbia to 1½ ft. Ø  
(central head & snake-like arms)  
Full sun  
Hardy to upper teens



***Nolina matapensis***  
Native to northwestern Mexico  
Grass-like heads to 8 ft. Ø; trunk to 15 ft.  
Full sun to partial shade  
Hardy to 15° F



***Agave xylonacantha***  
Native to eastern Mexico  
Single to several-headed; rosettes to 2-3 ft. Ø  
Full sun to partial shade  
Hardy to low 20's F



***Opuntia ficus-indica***  
(Prickly Pear)  
Native to: Mexico  
Shrub to 10-12 ft.  
Full sun  
Hardy to upper teens



***Yucca thompsoniana***  
Native to W. Texas & northern Mexico  
Tree-like, with heads to 3 ft. Ø & trunk to 10 ft.  
Full sun  
Hardy to 10° F



P

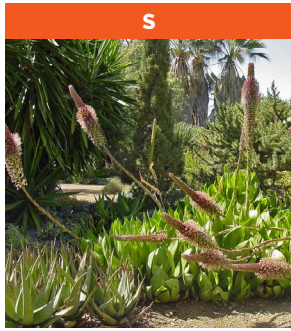

S

**Agave mitis**

(synonym: *Agave celsii*)  
Native to eastern Mexico  
Rosettes to 2' across, eventually forming a large clump  
Full sun to part shade  
Hardy to mid-20's



T

**Athanasia acerosa**

*Coulter Bush*  
Native to South Africa  
Shrub to 4 ft. tall  
Full sun  
Hardy to low 20's



Q

**Agave gypsophila**

Native to southern Mexico  
Clumper; stemless rosettes to 4 ft. Ø  
Full sun to partial shade  
Hardy to upper 20's F



U

**Grevillea 'Kings Fire'**

Hybrid; parents from Australia  
Shrub to 5-6 ft. tall  
Full sun  
Hardy to 25° F



R



**Parkinsonia 'Desert Museum'**

Hybrid with Mexican & SW U.S. parentage  
Tree to 25 ft. tall  
Full sun  
Hardy to 15° F

The Ruth Bancroft Garden and Nursery Map

No Entry Restroom Facilities

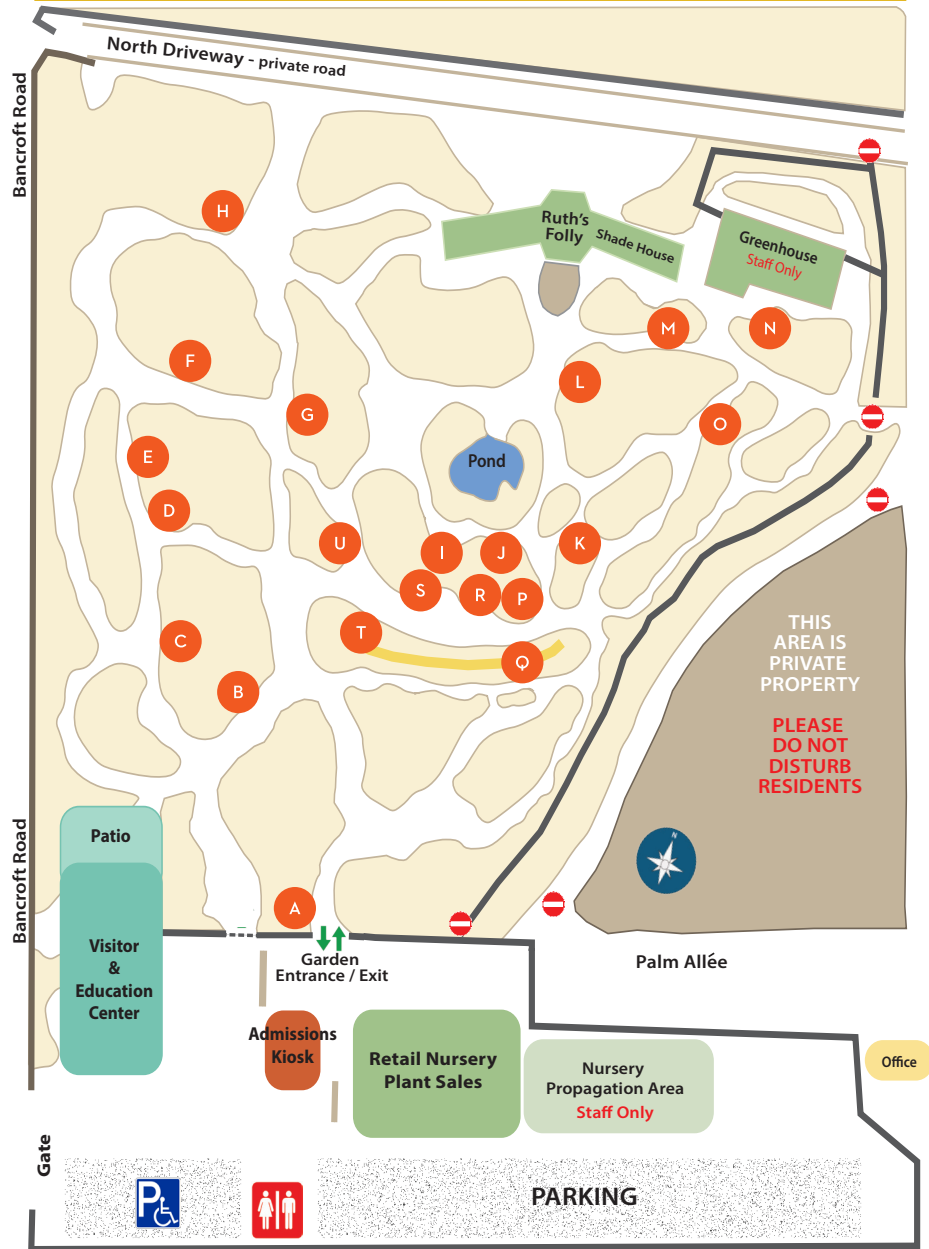

WHAT'S IN BLOOM  
Information Key



This plant or a similar variety is available for purchase in our nursery



indicates diameter