



A



***Yucca rigida***

Native to Mexico  
To 15 ft. tall  
Hardy to teens

B

NURSERY



***Penstemon heterophyllus***

California native  
Clumping perennial  
to 2–3 ft. θ  
Full sun  
Hardy to low teens F

C

NURSERY



***Trichostema lanatum***

Wooly Blue Curls  
California native  
Shrub, to 4 ft. high  
Full sun  
Hardy to 20°F

D



***Aloe buhrii***

Native to South Africa  
Single or few-headed clump  
Stemless rosette,  
to 2–3 feet θ  
Full sun  
Hardy to low 20s

E



***Leucospermum 'Succession'***

Hybrid; parents  
native to South Africa  
Shrub, to 6 ft. high  
Full sun / Hardy to 26°F

F

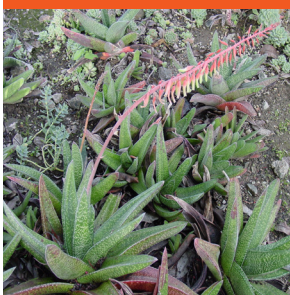

***Gasteria acinacifolia***

Native to South Africa  
Clump-forming & stemless  
with rosettes to 2½ ft. θ  
Filtered sun  
Hardy to 20° F

G



***Aloe comptonii x capitata***

Hybrid; parents from  
S. Africa & Madagascar  
Clumper w/ rosettes to 3 ft. θ  
Full sun to partial shade  
Hardy to 27° F

H



***Aloe capitata x cryptopoda***

Hybrid, with parents from  
Madagascar and South Africa  
Stemless clumper,  
to 2½ feet tall  
Full sun to partial shade  
Hardy to mid-20s

I



***Aquilegia shockleyi***

California native  
Perennial to 2 ft. tall  
Partial shade Hardy to 20° F

J



***Puya berteroniana***

Native to Chile  
Large bromeliad; clumps to 5  
ft. tall / Full sun  
Hardy to 20° F

K



***Agave xylonacantha***

Native to eastern Mexico  
Single to several-headed;  
rosettes to 2–3 ft. θ  
Full sun to partial shade  
Hardy to low 20s F

L



***Manfreda aff. sileri***

Native to Mexico  
Stemless rosettes to 2 ft. θ  
Partial shade  
Hardy to 20° F

M



***Ferocactus pilosus***

Native to Mexico  
Barrel cactus;  
single or clumping  
To 6–10 ft.  
Full sun  
Hardy to upper teens

(continues on other side)



# The Ruth Bancroft Garden What's in Bloom Map

Restroom Facilities Do Not Enter Markers (orient yourself in the direction of each arrow)

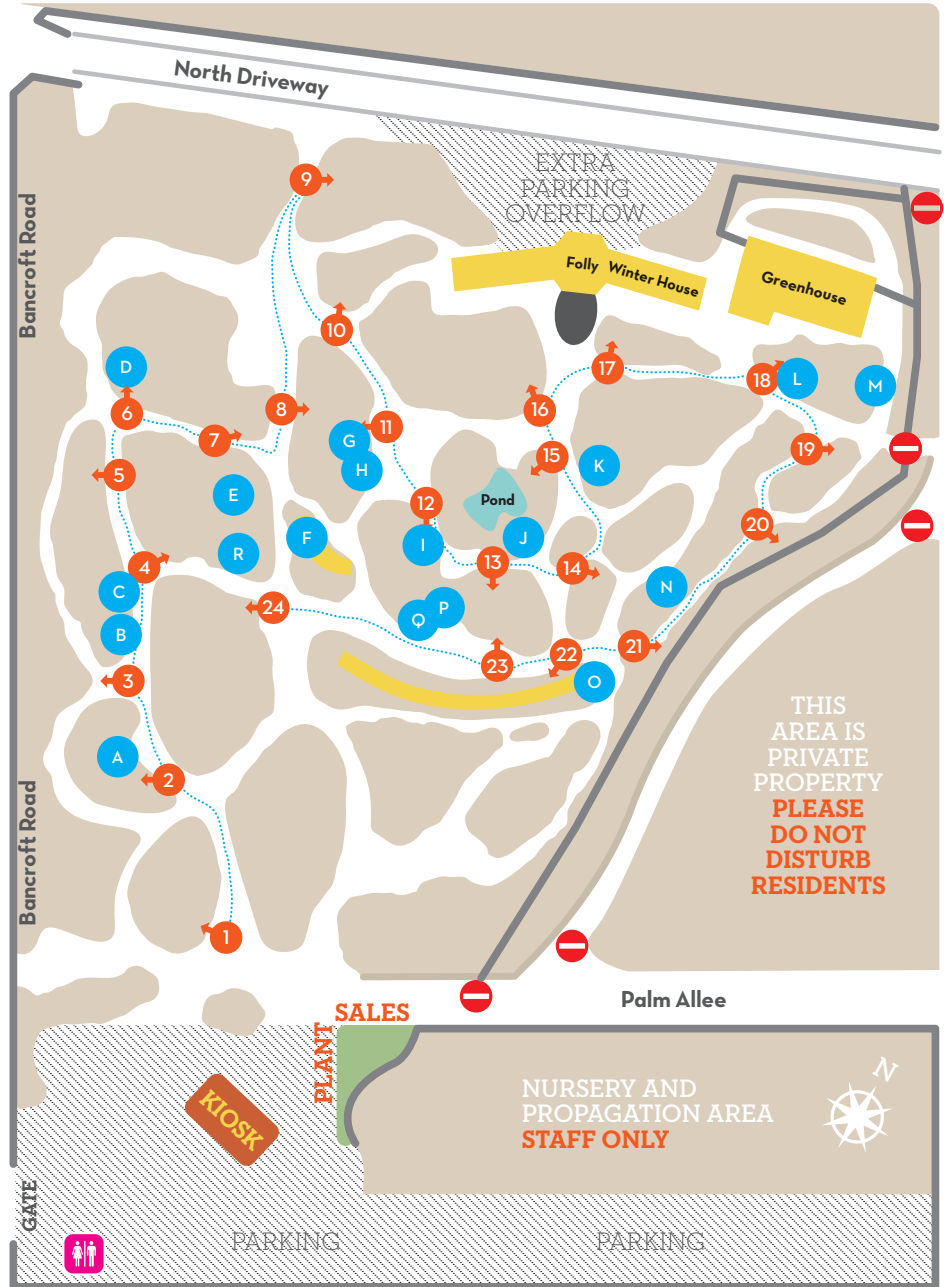

N

**Opuntia robusta**

Native to Mexico  
Large prickly-pear to 12 ft. tall  
Full sun  
Hardy to teens

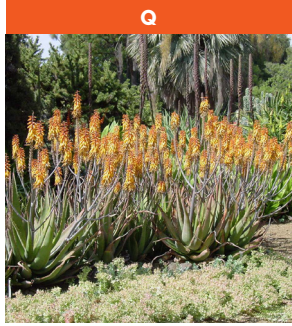

Q

**Aloe 'Gibson Hybrid'**

Clump-forming, rosettes to 2 ft.; flow. to 4 ft.  
Full sun to part shade  
Hardy to mid-20s

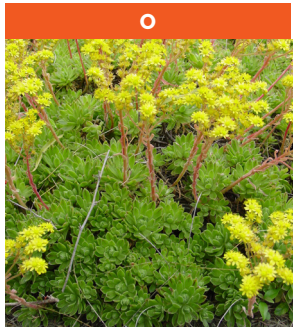

O

**Aeonium simsii**

Small clustering plant from the Canary Islands  
Full sun to part shade  
Hardy to mid-20s

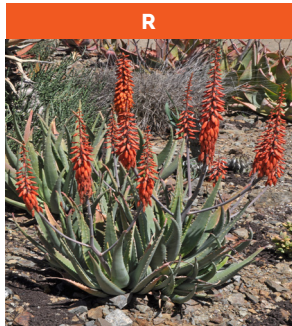

R



**Aloe 'Jam Suf'**

Red Sea Aloe  
Hybrid; parents from Ethiopia & Arabia  
Clumper; rosettes to 2 ft.  $\theta$   
Hardy to 27° F

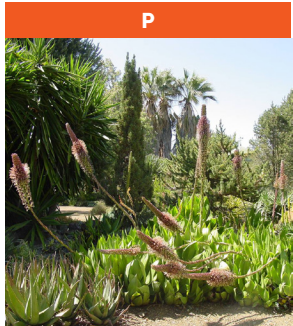

P

**Agave mitis**

synonym: *Agave celsii*  
Native to eastern Mexico  
Rosettes to 2 ft. across, eventually forming a large clump  
Full sun to part shade  
Hardy to mid-20s



## What's In Bloom Information Key



This plant or a similar variety is available for purchase in our nursery



indicates diameter