



A



***Brachycton discolor x acerifolius***

Hybrid; parents from Australia  
Tree to 50 ft.  
Full sun  
Hardy to low 20s° F

B



***Puya coerulea var. monteroana***

Native to Central Chile  
Stemless clumper from 3 ft. tall to 8 ft. wide  
Full sun to partial shade  
Hardy to 15° F

C



***Eriogonum giganteum***

St. Catherine's Lace

Native to Channel Islands, southern CA  
Shrub to 6 ft. tall  
Full sun to partial shade  
Hardy to 20° F

D



***Aloe 'Hellskloof Bells'***

Hybrid with South African parentage  
Clumper to 3 ft. tall  
Full sun  
Hardy to mid 20s° F

E



***Echeveria cante x subrigida***

Hybrid; parents from Mexico  
Stemless rosette to 1 ft. Ø  
Partial sun  
Hardy to mid- 20s° F

F

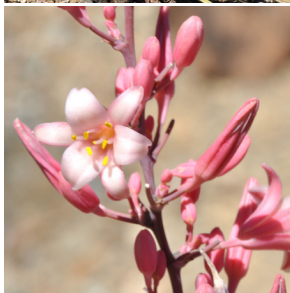

***Hesperaloe 'Pink Parade'***

Hybrid; parents from SW U.S. & Mexico  
Clumping, to 3–4 ft. tall  
Full sun to partial shade  
Hardy to -10° F

G

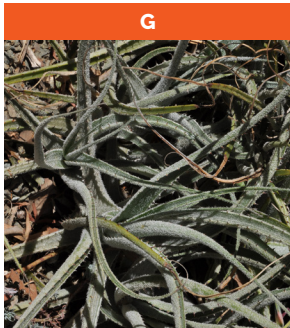

***Puya laxa***

Native to Argentina  
Clumper to 1½ ft. tall  
Full sun  
Hardy to 20° F

H

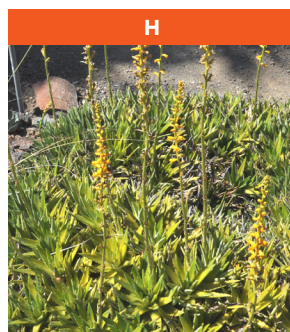

***Dyckia brevifolia***

Native to Brazil  
Clumper with rosettes to 5 in. across  
Full sun to part shade  
Hardy to low 20s° F

I



***Hesperaloe parviflora***

Native to Texas & northern Mexico  
Stemless clumper to 4 ft. tall  
Full sun to partial shade  
Hardy to 0° F

J



***Erythrina x bidwillii***

Hybrid (1 parent S. American, 1 N. American)  
Deciduous shrub to 8 ft. tall  
Full sun  
Hardy to 20° F

K

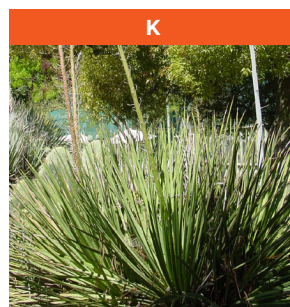

***Agave striata ssp. falcata***

Native to northeastern Mexico  
Rosettes to 3ft. Ø  
Full sun to part shade  
Hardy to 15° F

L

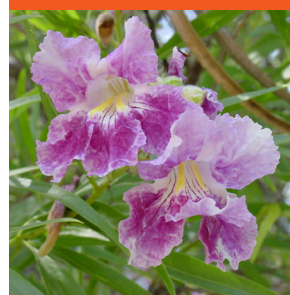

***Chilopsis linearis***

Desert Willow  
Native to SW U.S. & northern Mexico  
Tree to 25 ft. tall  
Full sun  
Hardy to 20° F

M





*Dasyliirion wheeleri*

Native to southwestern U.S. & northern Mexico  
Rosettes to 6ft. Ø  
Full sun to partial shade  
Hardy to 0° F

P



*Butia capitata*

*Jelly Palm*  
Native to South America  
Palm to 20 ft. tall  
Full sun  
Hardy to upper teens

N



Q



*Poliomintia longiflora*

Native to northeastern Mexico  
Shrub to 3-4 ft. tall  
Full sun  
Hardy to teens

*Hesperaloe nocturna*

Native to NW Mexico  
4-5 ft. tall clumps  
Full sun to partial shade  
Hardy to 25° F



*Agave filifera*

Native to central Mexico  
Clump-forming, with heads to 1½ ft. across  
Full sun to part shade  
Hardy to 20° F

R



*Alyogyne 'Ruth Bancroft'*

Hybrid, with both parents from Australia  
Shrub to 8 ft. tall  
Full sun  
Hardy to mid-20s

The Ruth Bancroft Garden WHAT'S IN BLOOM MAP

Restroom Facilities Do Not Enter Markers (orient yourself in the direction of each arrow)

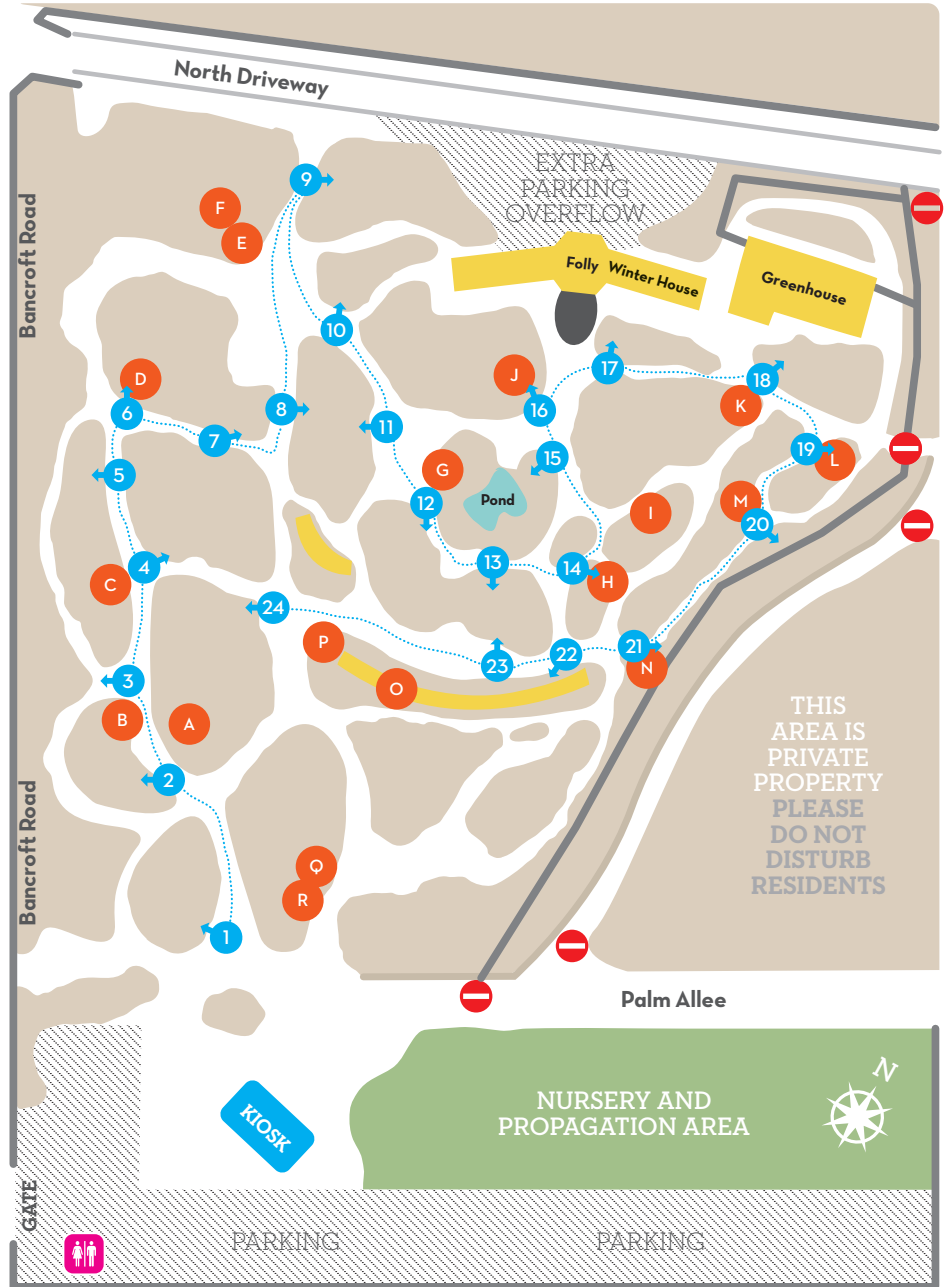

THIS AREA IS PRIVATE PROPERTY  
PLEASE DO NOT DISTURB RESIDENTS



WHAT'S IN BLOOM  
Information Key



This plant or a similar variety is available for purchase in our nursery



indicates diameter