



A



***Opuntia ficus-indica (fruit)***

Prickly Pear  
Native to: Mexico  
Shrub to 10-12 ft.  
Full sun  
Hardy to upper teens

B

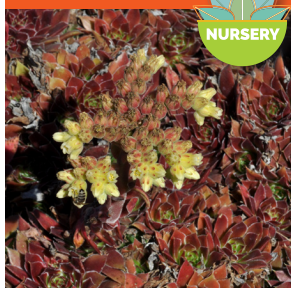

***Sempervivum (Jovibarba) heuffelii***

Native to the Balkan Peninsula  
Stemless clumper; rosettes to 3 in. Ø  
Light shade or full coastal sun  
Hardy to below 0° F

C



***Opuntia robusta (fruit)***

Native to Mexico  
Large prickly-pear to 12' tall  
Full sun  
Hardy to teens

D



***Malephora crocea***

Carpet plant with trailing stems  
Native to South Africa  
Full sun  
Hardy to low 20's

E



***Agave mitis (dwarf form)***

(synonym: *Agave celsii*)  
Native to eastern Mexico  
Rosettes to 1.5' across, eventually forming a clump  
Full sun to part shade  
Hardy to upper 20's

F



***Gasteria excelsa***

Native to South Africa  
Single stemless rosette to 2½ ft. Ø  
Shade to part sun  
Hardy to mid-20's

G



***Dyckia encholirioides***

Native to southern Brazil  
Clumper with rosettes to 2 ft. Ø  
Full sun to partial shade  
Hardy to low 20's

H



***Grevillea 'Kings Fire'***

Hybrid; parents from Australia  
Shrub to 5-6 ft. tall  
Full sun  
Hardy to 25° F

I



***Salvia azurea var. grandiflora***

Native to central U.S.  
Sprawling herbaceous plant to 3' tall  
Full sun  
Hardy to 15° F

J



***Plectranthus argentatus***

Native to Australia  
Spreading perennial to 5 ft. Ø  
Shade to partial shade  
Hardy to 28° F

K



***Calliandra 'Sierra Starr'***

Hybrid; parents native to SW USA & Mexico  
Small shrub 4-5 ft. tall  
Full sun  
Hardy to 15° F

L



***Butia capitata (fruit)***

Jelly Palm  
Native to Uruguay & Brazil  
Palm to 16 ft. tall  
Full sun  
Hardy to upper teens F

M



***Epilobium canum***

California Fuchsia  
California native  
Spreading perennial to 1½ ft. tall  
Full sun  
Hardy to mid-teens F

N



***Colletia paradoxa***

Anchor Plant  
Native to Uruguay & southern Brazil  
Shrub to 8 ft.  
Full sun  
Hardy to upper teens F

O



***Agave lophantha***

Native to eastern Mexico  
Rosettes to 3 ft. Ø  
Full sun to part shade  
Hardy to upper teens F

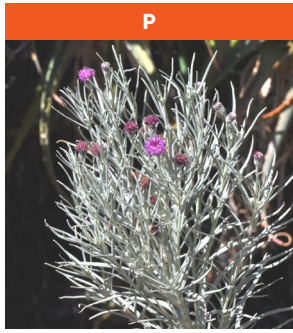

**Vernonia lindheimeri var. leucophylla**

Native to Texas & northern Mexico  
Perennial to 3 ft. tall  
Full sun  
Hardy to -10° F



**Russelia equisetiformis**

Coral Fountain; Firecracker Plant  
Native to Mexico  
Shrub to 4 – 5 ft.  
Full sun to partial shade  
Hardy to 25° F



**Pavonia missionum**

Native to Argentina, Paraguay, & Brazil  
Shrub to 6 ft. tall

Full sun to partial sun  
Hardy to 25° F



**Euphorbia inermis var. huttonae**

Native to South Africa  
Stemless "medusoid" euphorbia to 1½ ft. Ø (central head & snake-like arms)  
Full sun  
Hardy to upper teens



**Erythrina x bidwillii**

Hybrid (1 parent S. American, 1 N. American)  
Deciduous shrub to 8 ft. tall  
Full sun  
Hardy to 20° F

The Ruth Bancroft Garden WHAT'S IN BLOOM MAP

Restroom Facilities Do Not Enter Markers (orient yourself in the direction of each arrow)

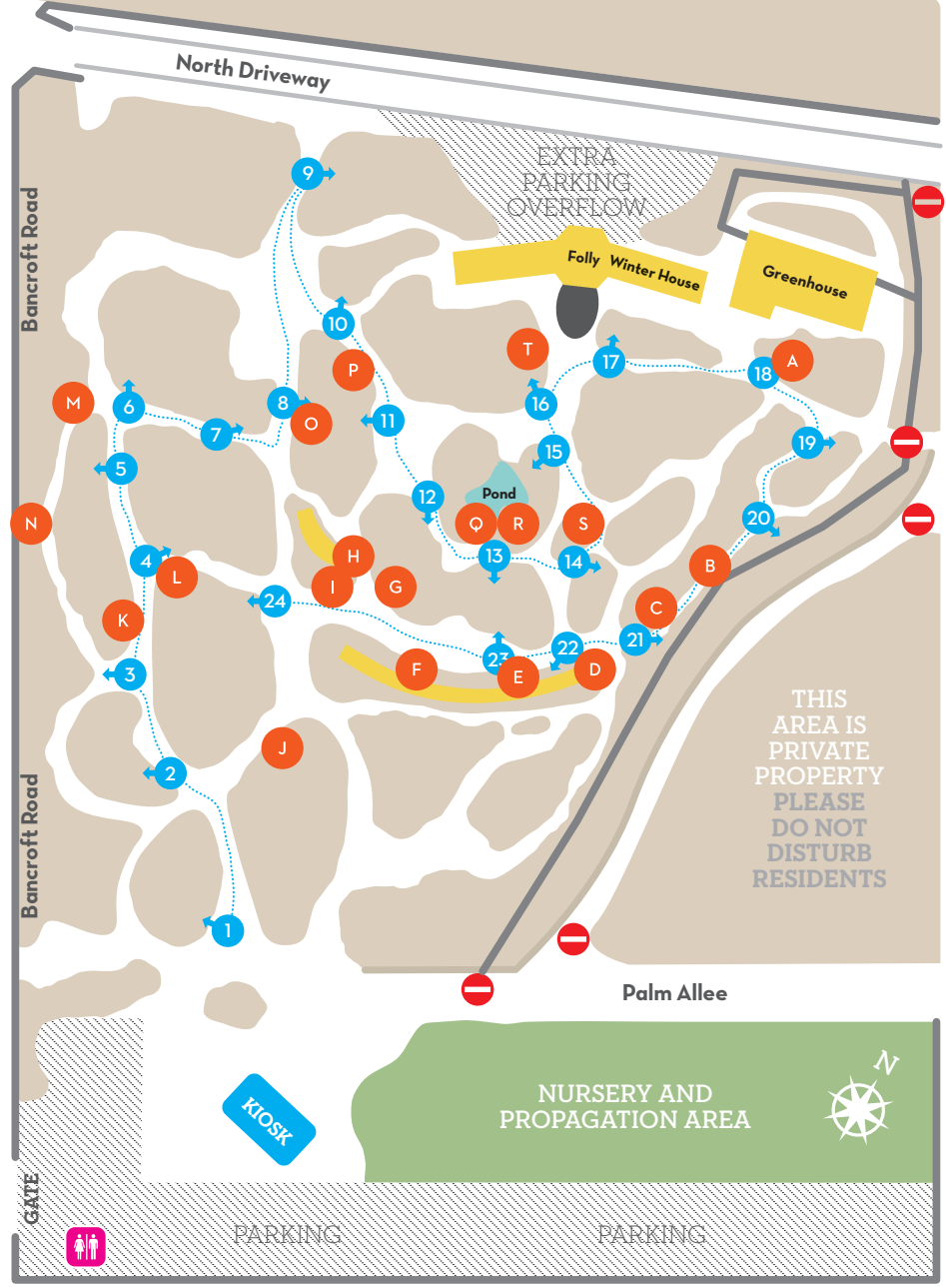

WHAT'S IN BLOOM Information Key



This plant or a similar variety is available for purchase in our nursery



indicates diameter