



Calliandra 'Sierra Star'
Hybrid; parents native to SW USA & Mexico
Small shrub 4 ft. tall
Full sun
Hardy to 15° F



Gossypium thurberi
Native to Arizona & northern Mexico
Shrub to 10 ft. tall
Full sun
Hardy to 15° F



Iris foetidissima (fruit)
POISONOUS FRUIT
Native to Europe
Stemless clump to 2 ft. tall
Partial shade
Hardy to 15° F



Opuntia leucotricha (fruit)
Native to central Mexico
Tree-like growth to 12 ft. tall
Full sun
Hardy to 20° F



Ceiba speciosa
(Chorisia speciosa)
Silk-floss tree
Native to South America
Tree to 50 ft.
Full sun
Hardy to low 20's F



Aloe vacillans (red flower)
Native to Saudi Arabia
Stemless rosettes to 1½ ft. Ø
Full sun to part shade
Hardy to 25° F



Aloe reitzii
Native to NE South Africa
Stemless single rosettes to 4 ft. Ø
Full sun to Partial shade
Hardy to mid-20's F



Puya ferruginea
Native to Ecuador, Peru, Bolivia
Clumping; stemless rosette to 1½ ft. Ø
Full sun
Hardy to upper 20's F

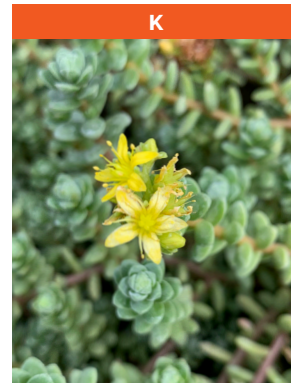

Sedum oaxacanum
Native to Mexico
Mat-forming, to 5 in. tall
Full sun to partial shade
Hardy to low 20's F



Aloe ellenbeckii
Native to Kenya & Somalia
Clumping, with stemless rosettes to 8 in. Ø
Full sun to partial shade
Hardy to 25° F



Justicia californica 'Tecate Gold'
Native to CA & AZ
Shrub to 5 ft. Ø
Full sun
Hardy to low 20's F



Senecio ficoides 'Skyscraper'
Native to western South Africa
Clumping; stems to 5 ft. tall
Full sun to partial shade
Hardy to 25° F



Aloe cheranganiensis
Native to Kenya
Shrub to 3-4 ft. tall
Full sun to part shade
Hardy to 28° F



Ferocactus pottsii (fruit)
Native to northern Mexico
Barrel cactus, to 1½ ft. tall
Full sun
Hardy to low 20's F

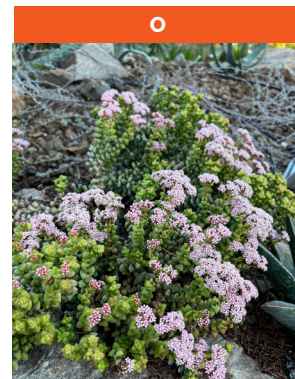

Crassula rupestris 'Tom Thumb'
Native to South Africa
Clump-forming, to 6 in. tall
Full sun to part shade
Hardy to 28° F



P



Aloe lukeana

Native to Uganda
Stemless rosette to 3 1/2 ft. Ø
Full sun to partial shade
Hardy to upper 20's F

S



Agave isthmensis

Native to southern Mexico
Rosettes to 1 1/2 ft. Ø
Full sun to partial shade
Hardy to upper 20's F

Q



Bulbine frutescens 'Hallmark'

Native to South Africa
Clump to 1 1/2 ft. tall
Full sun to partial shade
Hardy to 20° F

T



Aloe pendens

Native to Yemen
Clumping, with stems to 8 in.
Partial shade
Hardy to 28° F

R



Aloe vacillans (yellow flower)

Native to Yemen
Stemless rosettes to 1 1/2 ft. Ø
Full sun to part shade
Hardy to 25° F

U



Scabiosa farinosa

Native to Tunisia and Algeria
Subshrub 1 to 2 ft. tall
Full sun to partial shade
Hardy to low 20's F

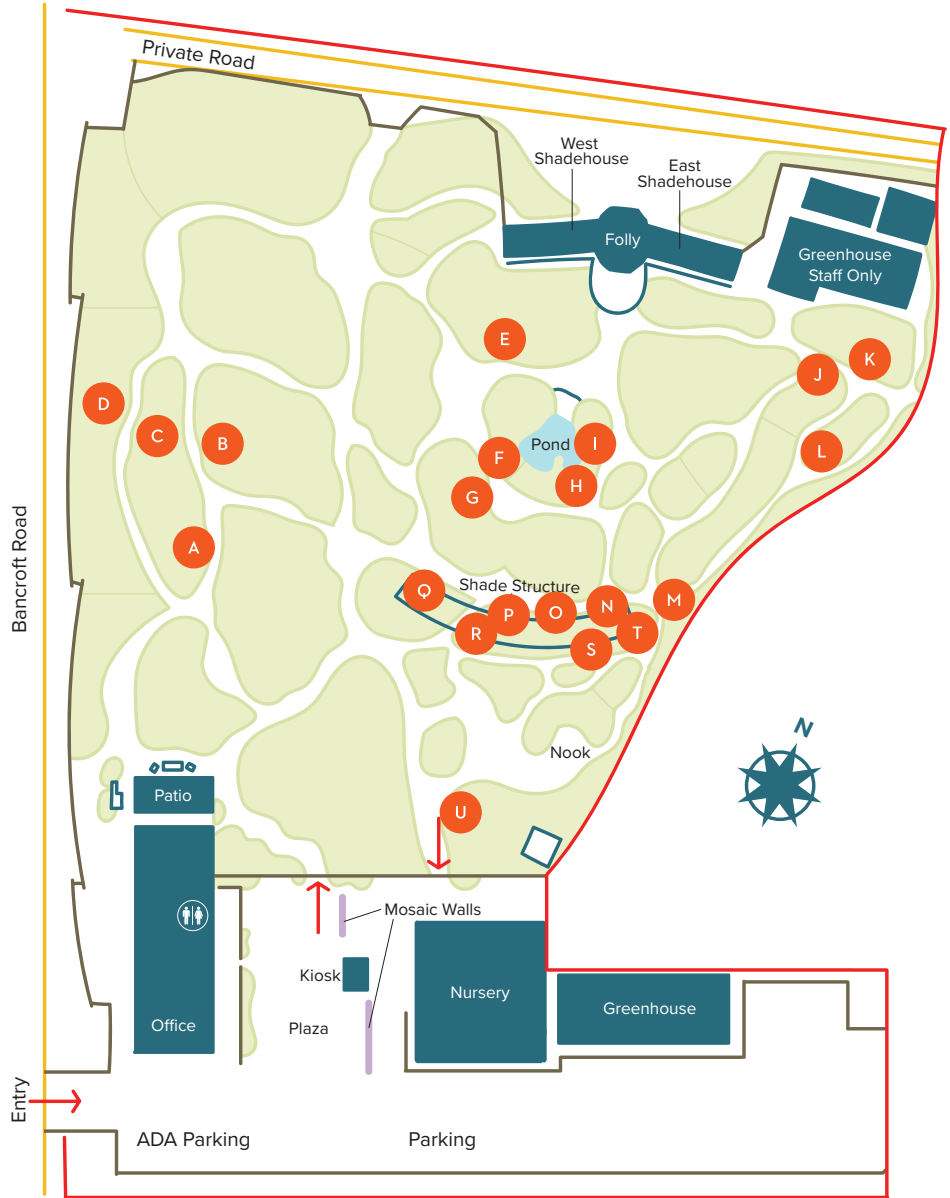

Scan the code to learn how you can support the Garden with a membership.



WHAT'S IN BLOOM
Information Key



This plant or a similar variety is available for purchase in the Nursery.



This plant was hybridized by Brian Kemble (Curator).



Indicates diameter.