



A

***Hakea petiolaris***

Native to Western Australia  
Upright shrub to 10-16 ft. tall  
Full sun  
Hardy to low 20's F



D

***Aloe schelpei***

Native to Ethiopia  
Stemless clumper; heads to 1½ ft. Ø  
Full sun to partial shade  
Hardy to low 20's F



G

***Aloe cheranganiensis***

Native to Kenya  
Shrub to 3-4 ft. tall  
Full sun to partial shade  
Hardy to 28° F



J

***Agave striata***

Native to Mexico  
Clumping, with heads to 2 ft. Ø  
Full sun to partial shade  
Hardy to 20° F

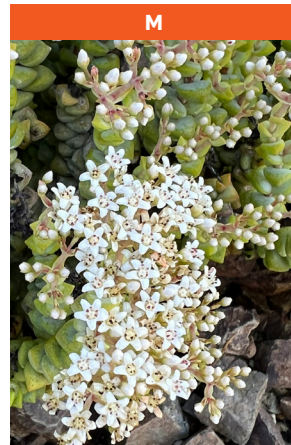

M

***Crassula 'Tom Thumb'***

Native to South Africa  
Clump-forming, to 6 in. tall  
Full sun to partial shade  
Hardy to 28° F

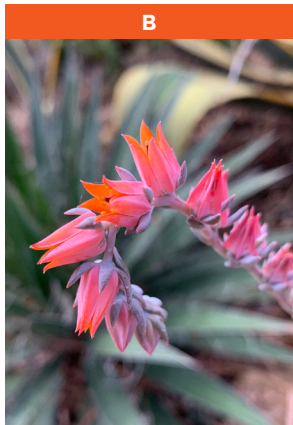

B

***Echeveria peacockii* hybrid**

Native to Eastern Mexico  
Stemless rosettes to 3-4" Ø  
Partial shade  
Hardy to upper 20's F



E

***Russelia equisetiformis***

(Coral Fountain; Firecracker Plant)  
Native to Mexico  
Shrub to 4 – 5 ft.  
Full sun to partial shade  
Hardy to 25° F



H

***Chamelaucium 'Matilda'***

Hybrid with Australian parentage  
Shrub to 3 ft. tall  
Full sun  
Hardy to 27° F



K

***Opuntia tomentosa* (fruit)**

Tree-like prickly pear  
Native to Mexico  
Full sun  
Hardy to mid-20's F



N

***Echeveria gigantea***

Native to Mexico  
Stem-forming, single; to 2ft. tall  
Partial shade  
Hardy to upper 20's F



C

***Eucalyptus polyanthemus***

Silver Dollar Gum  
Native to Australia  
Shrub to 5 ft. Ø  
Full sun  
Hardy to low 20's F



F

***Puya ferruginea***

Native to Ecuador Peru, Bolivia  
Clumping; stemless rosette to 1½ ft. Ø  
Full sun  
Hardy to upper 20's F



I

***Hakea verrucosa***

Native to Western Australia  
Shrub to 10 ft. tall  
Full sun  
Hardy to 27° F



L

***Aloe ellenbeckii***

(*Aloe dumetorum*)  
Native to Kenya & Somalia  
Clumping, with stemless rosettes to 8 in. Ø  
Full sun to partial shade  
Hardy to 25°



O

***Aloe lukeana***

Native to Uganda  
Stemless rosette to 3½ ft. Ø  
Full sun to partial shade  
Hardy to upper 20's F



P



**Aloe 'GW Miller'**

Hybrid with parents from Sudan & Socotra  
Clumper with heads to 7 in. Ø  
Partial shade  
Hardy to upper 20's F

S



**Aloe humilis x africana**

Hybrid; parents from S. Africa  
Stemless clumper; rosettes to 8" Ø  
Full sun to part shade  
Hardy to 25° F

Q



**\*Pachyveria hybrid**

Hybrid with Mexican parentage  
Stem-forming clump to 1 foot tall  
Full sun to part shade  
Hardy to mid-20's F

T



**Aloe vacillans**

Native to Arabia  
Stemless rosettes to 1½ ft. Ø  
Full sun to part shade  
Hardy to 25° F

R



**Senecio serpens**

(*Curio repens*)  
Native to South Africa  
Clumping, to 1 foot tall  
Full sun to partial shade  
Hardy to low 20's F

U



**Aloe pendens**

Native to Yemen  
Clumping, with stems to 8 in.  
Partial shade  
Hardy to 28° F

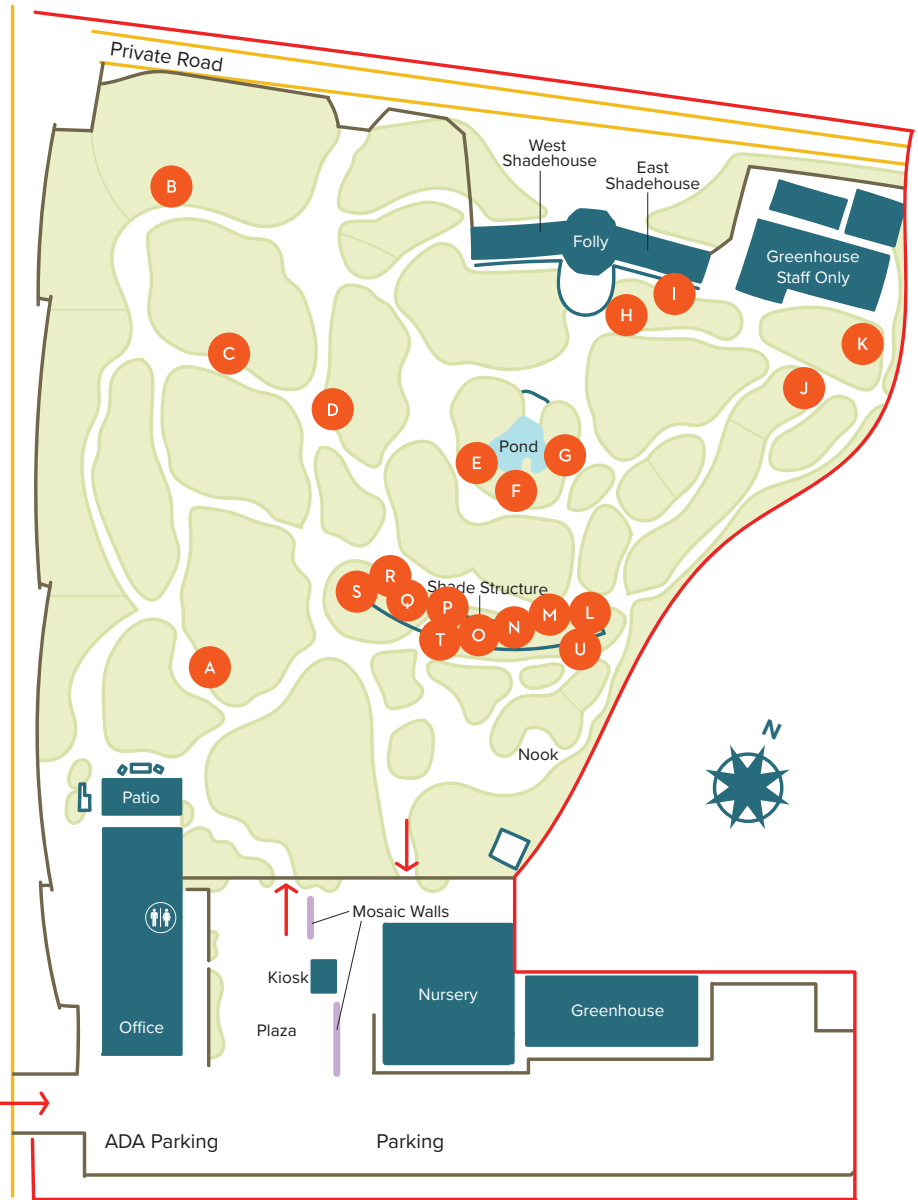

Scan the code to learn how you can support the Garden with a membership.



WHAT'S IN BLOOM  
Information Key



This plant or a similar variety is available for purchase in the Nursery.



This plant was hybridized by Brian Kemble (Curator).



Indicates diameter.