



A

Thunbergia alata

Black-eyed Susan Vine
Native to East Africa
Vine
Full sun to partial shade
Hardy to 25° F



D

Eucalyptus polyanthemos

Silver Dollar Gum
Native to Australia
Tree to 75 ft.
Full sun to partial shade
Hardy to 18° F



G

NURSERY

Othonna capensis

Native to SW South Africa
Ground cover
Full sun to part shade
Hardy to low 20's ° F



J

Chamelaucium 'Matilda'

Hybrid with Australian parentage
Shrub to 3 ft. tall
Full sun
Hardy to 27° F

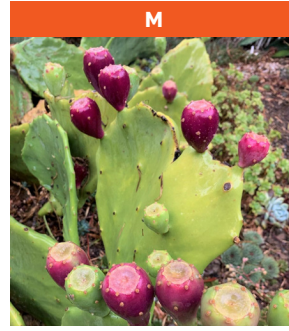

M

Opuntia gomei 'Old Mexico' (fruit)

Native to S. Texas & NE Mexico
Shrubby prickly-pear to 4-5 ft. tall
Full sun to partial shade
Hardy to low teens ° F



B

Aloe schelpei

Native to Ethiopia
Stemless clumper; heads to 1½ ft. Ø
Full sun to partial shade
Hardy to low 20's ° F



E

Crassula sarcocaulis

Native to SE Africa
Shrub to 3 ft. high
Full sun to partial shade
Hardy to 20° F



H

Trithrinax campestris

Native to Argentina & Uruguay
To 20' tall
Full sun to partial shade
Hardy to 15° F



K

Agave striata

Native to Mexico
Clumping, with heads to 2 ft. Ø
Full sun to partial shade
Hardy to 20° F



N

Echeveria 'Mauna Loa'

Hybrid; parents from Mexico
Single-headed, to 1½ ft. Ø
Light shade
Hardy to upper 20's ° F



C

Justicia californica 'Tecate Gold'

CA & AZ native
Shrub to 5 ft.
Full sun
Hardy to low 20's ° F

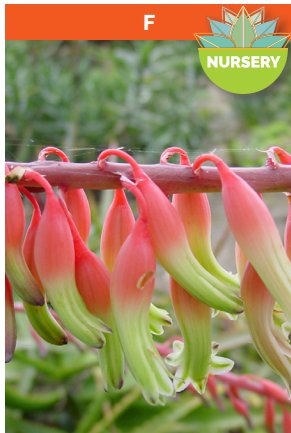

F

NURSERY

Gasteria acinacifolia

Native to South Africa
Clump-forming & stemless with rosettes to 2½' Ø
Filtered sun
Hardy to 20° F



I

NURSERY

Echeveria lilacina hybrid

Hybrid with Mexican parentage
Stemless rosette to 8" Ø
Partial shade
Hardy to upper 20's ° F

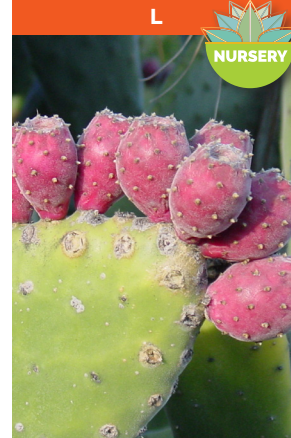

L

NURSERY

Opuntia tomentosa (fruit)

Tree-like prickly pear
Native to Mexico
Full sun
Hardy to mid-20's



O

Aloe cryptopoda

Native to NE South Africa
Stemless clumper; rosettes to 3' Ø
Full sun to partial shade
Hardy to 25° F



P

Aloe secundiflora

Native to East Africa
Rosettes to 3 ft. Ø
Full sun to partial shade
Hardy to 30° F

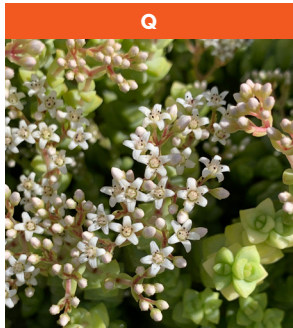

Q

Crassula 'Tom Thumb'

Native to South Africa
Clump-forming, to 6 in. tall
Full sun to partial shade
Hardy to 28° F

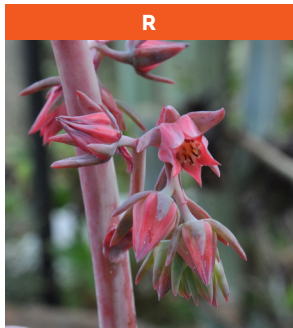

R

Grevillea 'Kings Fire'

Hybrid; parents from Australia
Shrub to 5-6 ft. tall
Full sun
Hardy to 25° F



Echeveria gigantea

Native to Mexico
Stem-forming, single; to 2 ft. tall
Partial shade
Hardy to upper 20's ° F



S



Aloe vacillans

Native to Arabia
Stemless rosettes to 1½ ft. Ø
Full sun to part shade
Hardy to 25° F



T

Glottiphyllum oligocarpum

Native to South Africa
Short clumps with leaves to 4 in. long
Full sun to partial shade
Hardy to 25° F



U

Glottiphyllum oligocarpum

Native to South Africa
Short clumps with leaves to 4 in. long
Full sun to partial shade
Hardy to 25° F

The Ruth Bancroft Garden and Nursery Map

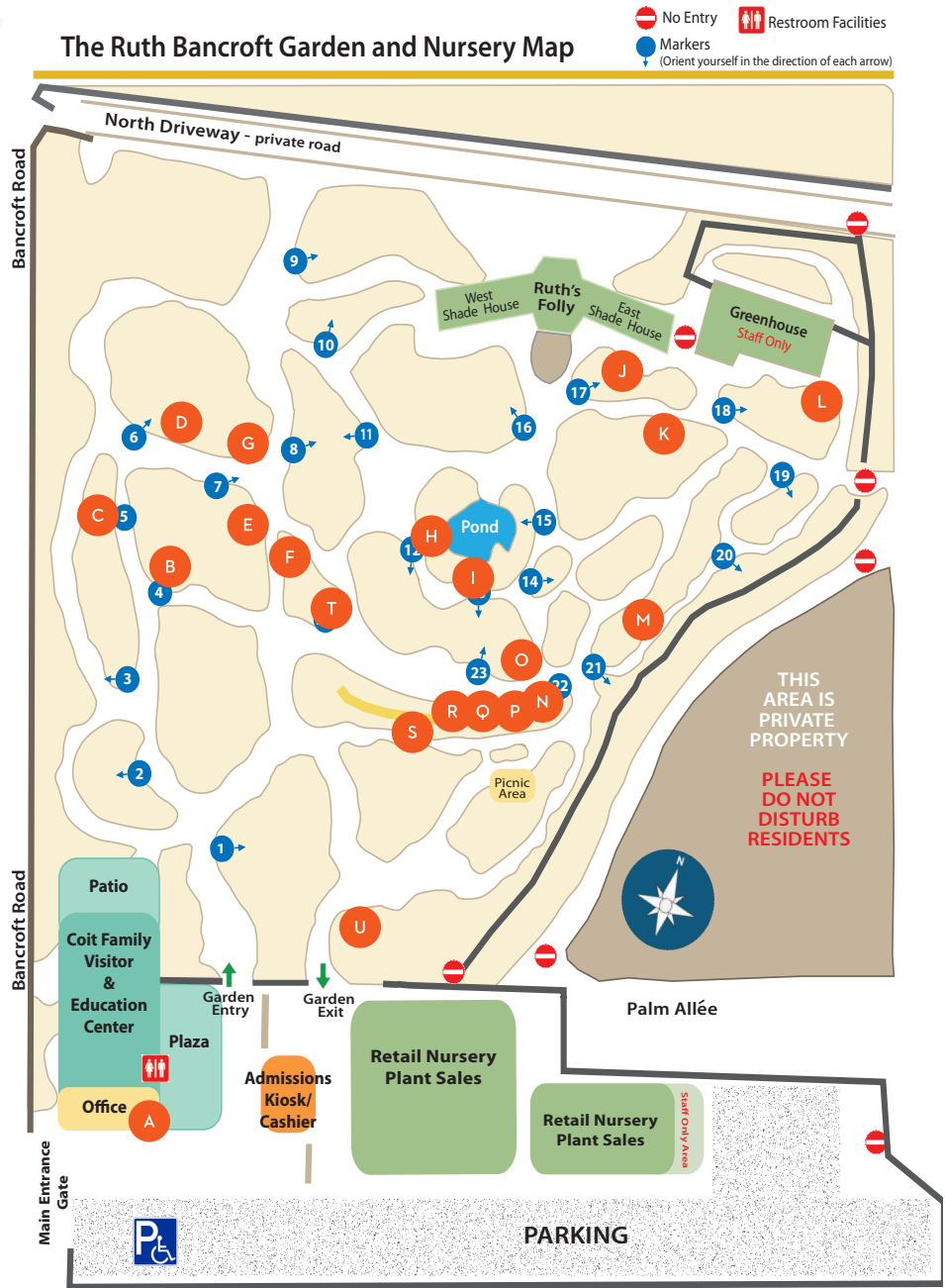

WHAT'S IN BLOOM
Information Key



This plant or a similar variety is available for purchase in our nursery



indicates diameter