



A
Anigozanthos 'Amber Velvet'
Hybrid with Western Australian parentage
Clumping perennial to 2 ft. tall; flower stalks are taller
Full sun
Hardy to 25°F



D
Heteromeles arbutifolia (fruit)
(Toyon)
California Native
Shrub or small tree to 20 ft.
Full sun to partial shade
Hardy to 10° F



G
Aloe fosteri
Native to northeastern S. Africa
Stemless rosettes to 3 ft. Ø
Full sun to partial shade
Hardy to mid-20's F



J
Echeveria lilacina hybrid
Hybrid with Mexican parentage
Stemless rosette to 8" Ø
Partial shade
Hardy to upper 20's° F



M
Agave potatorum
Native to southern Mexico
Stemless rosette to 2½ft. Ø
Full sun to partial sun
Hardy to 27° F



B
Dasyliirion longissimum hybrid
Native to eastern Mexico
Rosettes to 9' Ø
Full sun to partial shade
Hardy to 15° F



E
Ruschia dichroa
Native to western S. Africa
Small shrublet
Full sun
Hardy to mid-20's



H
Banksia ashbyi
Native to Western Australia
Shrub to 12 ft. tall
Full sun
Hardy to 22° F

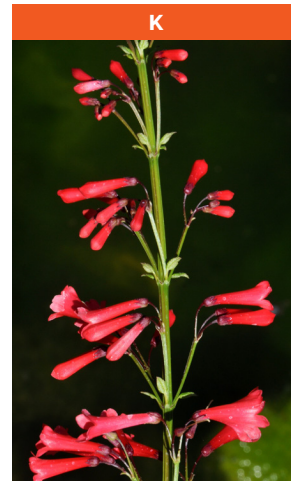

K
Russelia equisetiformis
(Coral Fountain; Firecracker Plant)
Native to Mexico
Shrub to 4 – 5 ft.
Full sun to partial shade
Hardy to 25° F



N
Opuntia tomentosa (fruit)
Tree-like prickly pear
Native to Mexico
Full sun
Hardy to mid-20's F



C
Aloe schelpei
Native to Ethiopia
Stemless clumper; heads to 1½ ft. Ø
Full sun to partial shade
Hardy to low 20's



F
Eucalyptus polyanthemus
Silver Dollar Gum
Native to Australia
Tree to 75 ft.
Full sun to partial shade
Hardy to 18° F



I
****Mangave 'Inkblot'***
Hybrid with Mexican parentage
Stemless rosettes to 1½ft. Ø
Full sun to partial shade
Hardy to 25° F



L
Aloe cheranganiensis
Native to Kenya
Shrub to 3 – 4 ft. tall
Full sun to partial shade
Hardy to 28° F



O
Aloe cryptopoda
Native to NE South Africa
Stemless clumper; rosettes to 3' Ø
Full sun to partial shade
Hardy to 25° F



Aloe ellenbeckii

(synonym: *Aloe dumetorum*)
 Native to Kenya & Somalia
 Clumping, with stemless rosettes to 8 in. Ø
 Full sun to partial shade
 Hardy to 25° F



Aloe vacillans

Native to Arabia
 Stemless rosettes to 1½ ft. Ø
 Full sun to part shade
 Hardy to 25° F



Echeveria gigantea

Native to Mexico
 Stem-forming, single; to 2 ft. tall
 Partial shade
 Hardy to upper 20's

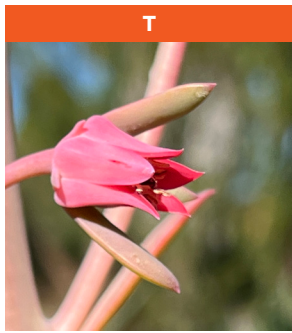

Echeveria gibbiflora

Hybrid; parents from Mexico
 Single-headed, to 1½ ft. Ø
 Light shade
 Hardy to upper 20's



Euphorbia clandestina

Native to South Africa
 Erect cylindrical succulent stem to 2 ft. tall
 Full sun to partial shade
 Hardy to 25° F

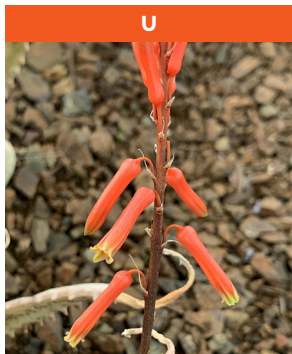

Aloe tororoana

Native to Uganda
 Clumping, with short-stemmed rosettes to 1 ft. Ø
 Full sun to partial shade
 Hardy to upper 20's F

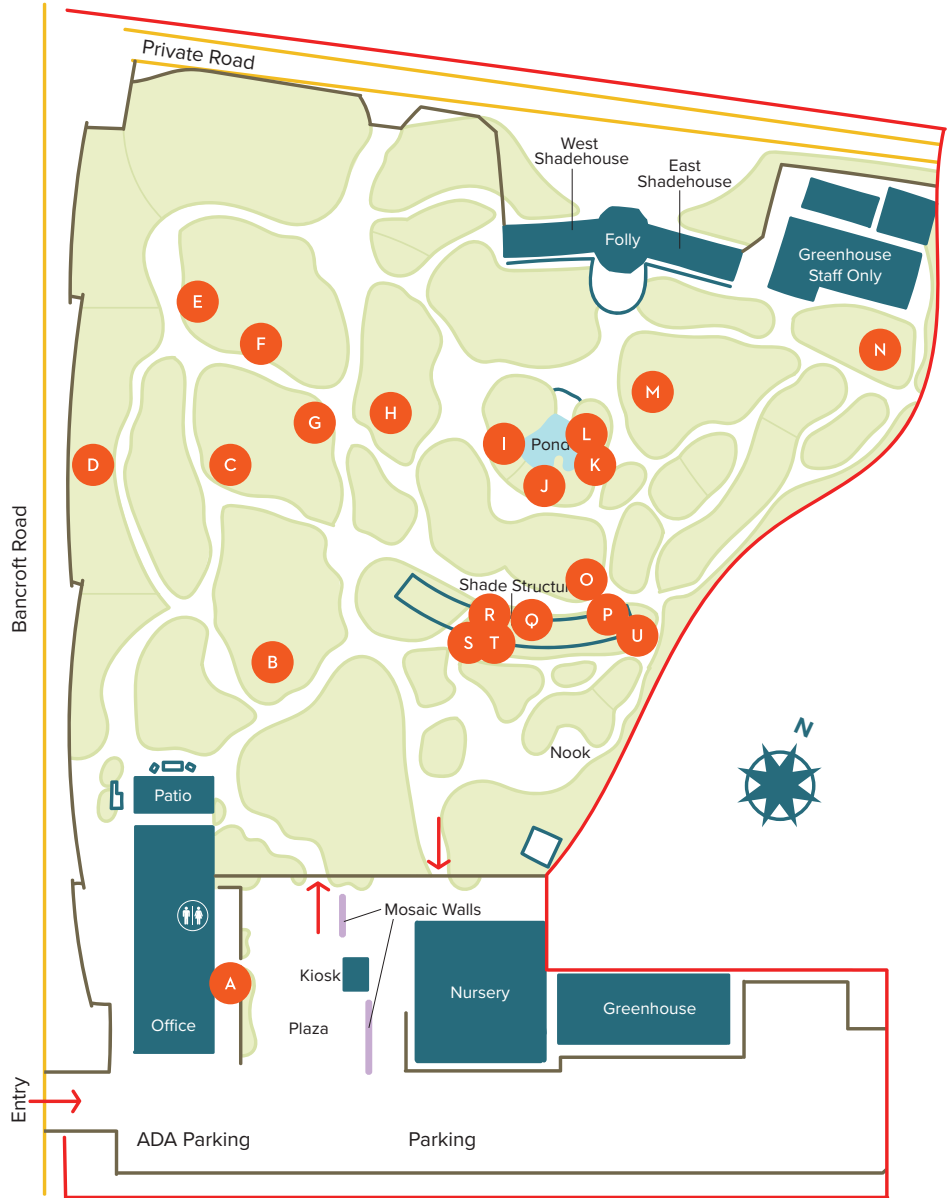

WHAT'S IN BLOOM
 Information Key



This plant or a similar variety is available for purchase in our nursery



indicates *diameter*