



A

Agave ovatifolia

Native to NE Mexico
Solitary rosette to 6 ft. Ø
Full sun to partial shade
Hardy to upper teens F



B

Dudleya viscida

California native
Stemless clump to 2 ft. Ø
Full sun to partial shade
Hardy to mid-20's F



C

Parkinsonia florida

(*Cercidium floridum*; blue palo verde)
Native to SW U.S. & Mexico
Tree to 25 ft. tall
Full sun
Hardy to 20° F



D

Aloe woodii

Native to Arabia
Stemless rosette to 3 ft. Ø
Full sun
Hardy to 25°F



E

Hesperaloe funifera

Native to Texas & Mexico
Clump to 6 ft. tall
Full sun
Hardy to below 0° F



F

Aloe rivae

Native to Kenya & Ethiopia
Stemless rosette to 3 ft. Ø
Full sun to partial shade
Hardy to upper 20's F



G

Albuca nelsonii

Native to South Africa
Clump-forming, to 3-4' tall
Partial shade
Hardy to mid-20's



H

Yucca thompsoniana

Native to W. Texas & northern Mexico
Tree-like, with heads to 3 ft. Ø & trunk to 10 ft.
Full sun
Hardy to 10° F



I

Gasteria carinata v. glabra

Native to South Africa
Stemless rosette to 8 in. Ø
Partial shade (or full sun on coast)
Hardy to 25° F



J

NURSERY

Euphorbia inermis var. huttonae

Native to South Africa
Stemless "medusoid" euphorbia to 1½ ft. Ø
(central head & snake-like arms)
Full sun
Hardy to upper teens



K

Tanacetum haradjani

Native to Syria
Mat-forming, to 8 in. tall
Full sun
Hardy to 15° F



L

Yucca filifera

Native to Mexico
Tree-like to 25 ft. tall
Full sun to partial shade
Hardy to 20° F



M

NURSERY

Opuntia ficus-indica

(Prickly Pear)
Native to Mexico
Shrub to 10-12 ft.
Full sun
Hardy to upper teens



N

NURSERY

Chilopsis linearis

(Desert Willow)
Native to SW U.S. & northern Mexico
Tree to 25' tall
Full sun
Hardy to 20° F



O

Agave lophantha

Native to eastern Mexico
Rosettes to 3 ft. Ø
Full sun to part shade
Hardy to upper teens F



P

NURSERY

Sinningia 'Shelby'

Parents native to South America
Tuberous winter-dormant perennial
Full sun to partial shade
Hardy to low 20's F



S

Romneya coulteri

(Matilija Poppy)
Native to California
Perennial to 4-5 ft. x 8 ft. wide
Full sun to partial shade
Hardy to 10° F



Q

Aloe pseudorubroviolacea

Native to Saudi Arabia
Short-stemmed rosettes to 4 ft. Ø
Full sun to partial shade
Hardy to 25° F



T

***Buddleja davidii* cv.**

Native to China
Shrub to 10 ft. tall
Full sun to partial shade
Hardy to 5° F



R

Agave mitis

(*Agave celsii*)
Native to eastern Mexico
Rosettes to 2' across, eventually forming a large clump
Full sun to part shade
Hardy to mid-20's



U

NURSERY

Phymaspermum acerosum

(*Athanasia acerosa*; Coulter Bush)
Native to South Africa
Shrub to 4 ft. tall
Full sun
Hardy to low 20's

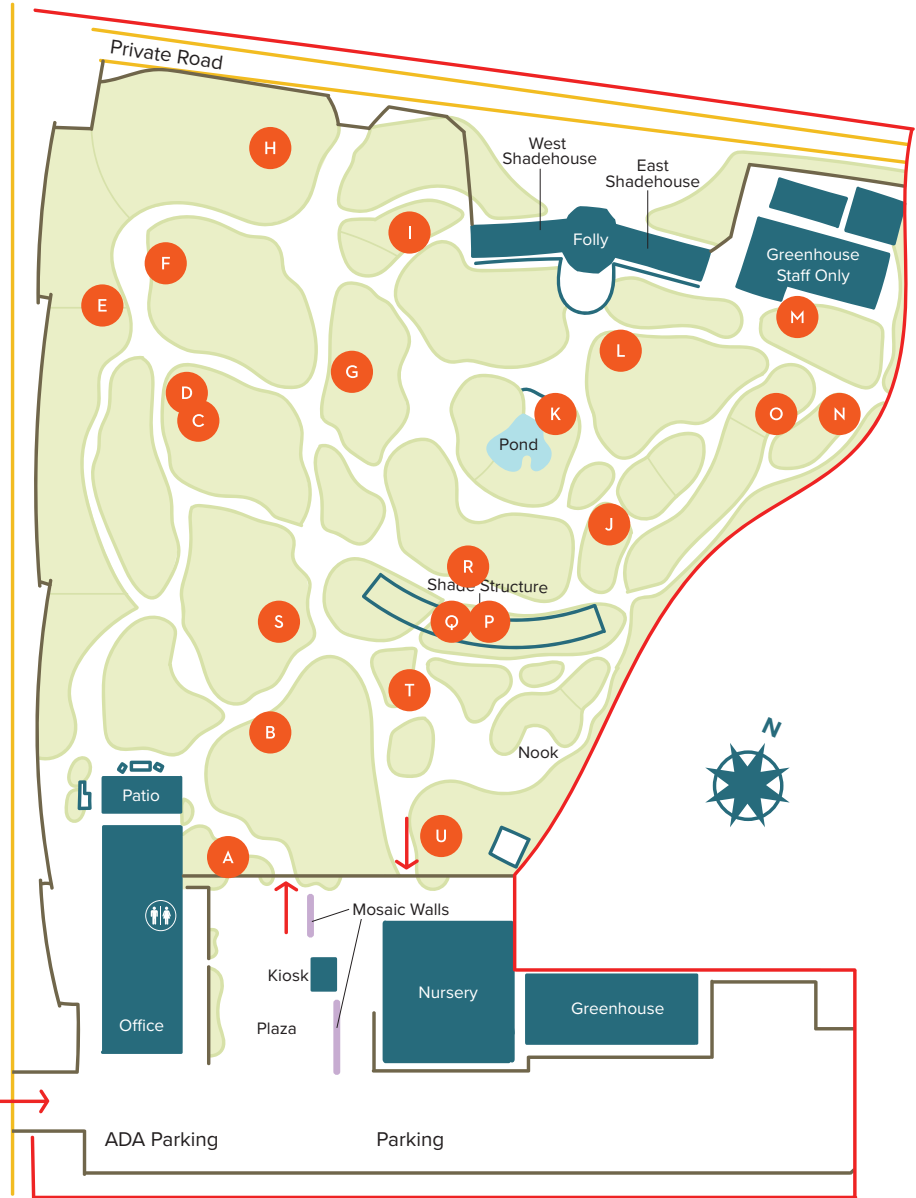

Scan the code to learn how you can support the Garden with a membership.



WHAT'S IN BLOOM
Information Key



This plant or a similar variety is available for purchase in the Nursery.



This plant was hybridized by Brian Kemble (Curator).



Indicates diameter.