



A



Yucca rostrata

Native to northern Mexico & W. Texas
Tree-like to 15' tall, sparingly branched
Full sun
Hardy to 10° F

B



Brachychiton discolor* * *acerifolius

Hybrid; parents from Australia
Tree to 50 ft.
Full sun
Hardy to low 20's F

C



Eriogonum fasciculatum
(California Buckwheat)

Native to California & Baja California
Clump; 1-3' tall x 4' wide
Full sun
Hardy to 15° F

D

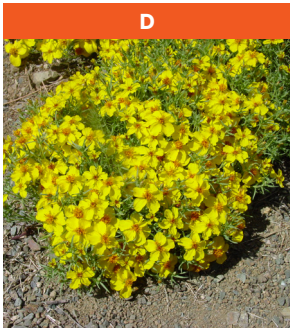

Zinnia grandiflora

Native to western U.S. & northern Mexico
Subshrub less than a foot tall
Full sun
Hardy to below 0° F

E



Hesperoyucca whipplei

(Our Lord's Candle)
Native to CA & northern Baja California
Stemless rosette, single or clump-forming
Full sun
Hardy to teens

F



Banksia ashbyi

Native to Western Australia
Shrub to 12 ft. tall
Full sun
Hardy to 22° F

G



Agave tequilana

Native to Mexico
Stemless rosettes to 6 ft. +
Full sun to partial shade
Hardy to 20° F

H

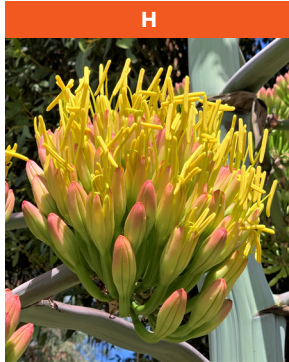

Agave ovatifolia

Native to northeastern Mexico
Solitary rosette to 6 ft. 0
Full sun to partial shade
Hardy to upper teens F

I



Xanthorrhoea preissii

Australian grass tree
Native to Western Australia
Long needle-like leaves atop a short trunk
Full sun to partial shade
Hardy to upper teens

J

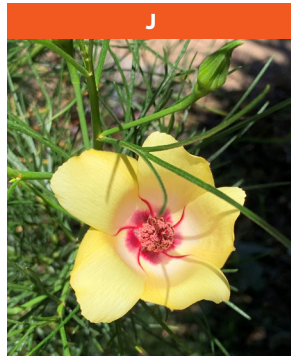

***Alyogyne hakeifolia* (yellow)**

Native to southern Australia
Shrub to 8 ft. tall
Full sun to light shade
Hardy to upper 20's F

K



Scabiosa ochroleuca

Native to Mediterranean area
Shrub to 3 ft. tall
Full sun to light shade
Hardy to below 0° F

L



Dyckia brevifolia

(*Dyckia sulphurea*)
Native to Brazil
Clumper with rosettes to 5" across
Full sun to part shade
Hardy to low 20's

M



Yucca filifera

Native to Mexico
Tree-like to 25 ft. tall
Full sun to partial shade
Hardy to 20° F

N



Yucca thompsoniana

Native to W. Texas & northern Mexico
Tree-like, with heads to 3 ft. 0 & trunk to 10 ft.
Full sun
Hardy to 10° F

O

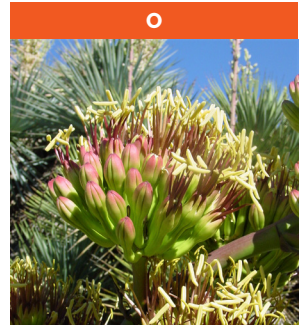

Agave colorata

Native to northwestern Mexico
Rosettes to 2 ft. 0
Full sun to partial shade
Hardy to mid-20's F



P

***Opuntia gomei* 'Old Mexico'**

Native to S. Texas & NE Mexico
Shrubby prickly-pear to 4-5 ft. tall
Full sun to partial shade
Hardy to low teens F



S

***Aloe* 'GW Miller'**

Hybrid with parents from Sudan & Socotra
Clumper with heads to 7 in. Ø
Partial shade
Hardy to upper 20's F



Q

***Parkinsonia* 'Desert Museum'**

Hybrid with Mexican & SW U.S. parentage
Tree to 25 ft. tall
Full sun
Hardy to 15° F



T

Romneya coulteri

Matilija Poppy
Native to CA
Perennial to 4-5 ft. x 8 ft. wide
Full sun to partial shade
Hardy to 10° F



R

Agave mitis

(*Agave celsii*)
Native to eastern Mexico
Rosette to 2' across, eventually forming a large clump
Full sun to part shade
Hardy to mid-20's



U

Phymatospermum acerosum

(*Athanasia acerosa*)
Coulter Bush
Native to South Africa
Shrub to 4 ft. tall
Full sun
Hardy to low 20's

The Ruth Bancroft Garden and Nursery Map

No Entry
 Restroom Facilities
 Markers
 (Orient yourself in the direction of each arrow)

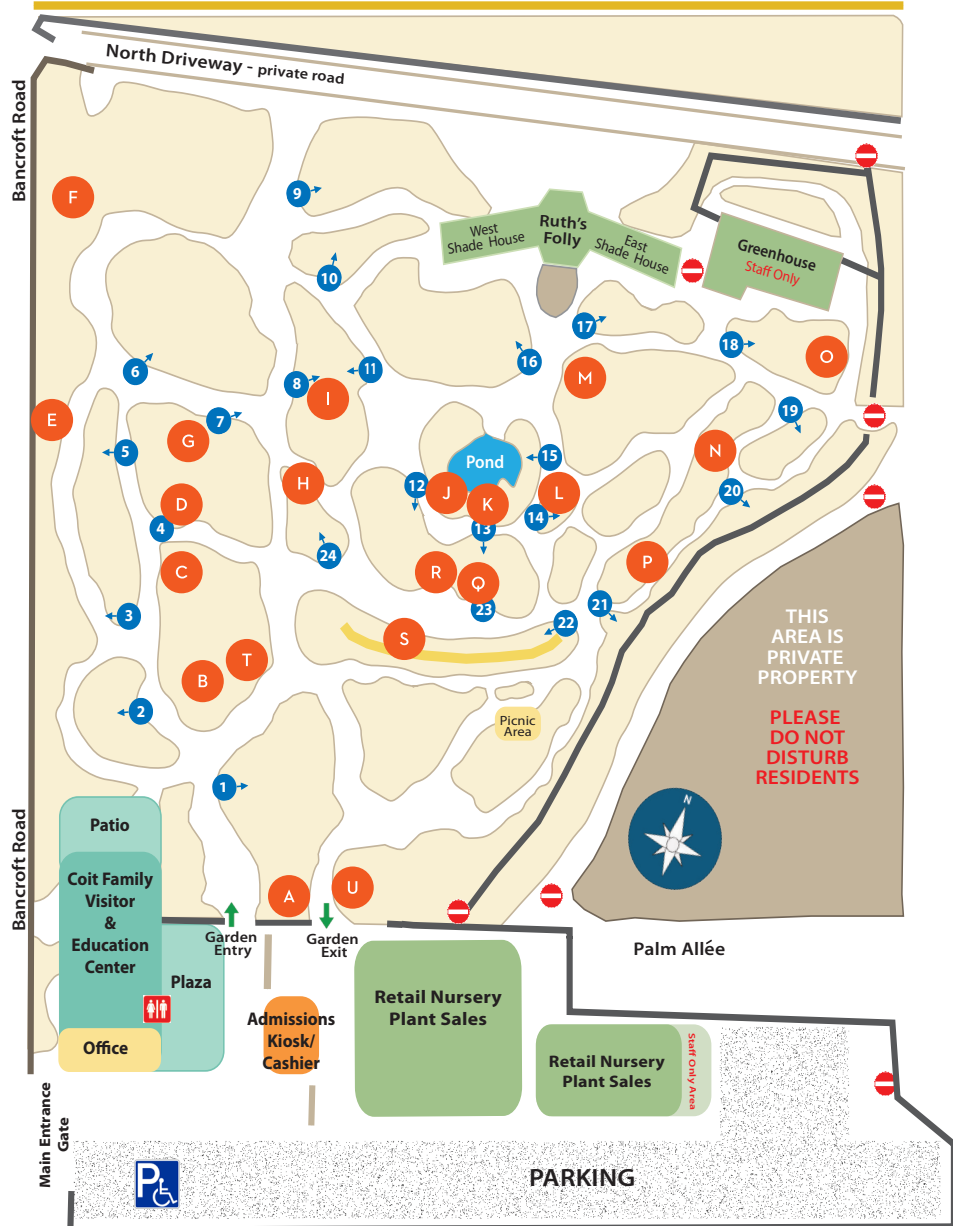

WHAT'S IN BLOOM
Information Key



This plant or a similar variety is available for purchase in our nursery



indicates diameter