



**A**  
*Lachenalia viridiflora*  
Native to South Africa  
Bulb to 6 in. tall  
Full sun to part shade  
Hardy to low 20's F



**D**  
*Arctostaphylos 'Austin Griffiths'*  
Hybrid; parents are CA natives  
Shrub to 10' tall  
Full sun  
Hardy to 10° F



**G**  
*Aloe 'Tangerine'*  
Hybrid; parents native to S. Africa  
Multi-stemmed, to 8 ft. tall  
Sun to part shade  
Hardy to 24° F



**J**  
*Aloe mutabilis*  
Native to South Africa  
Clump to 3 ft. tall  
Full sun to partial shade  
Hardy to low 20's



**M**  
*Echeveria lilacina hybrid*  
Hybrid with Mexican parentage  
Stemless rosette to 8" Ø  
Partial shade  
Hardy to upper 20's° F



**B**  
*Hakea petiolaris*  
Native to Western Australia  
Upright shrub to 10 – 16 ft. tall  
Full sun  
Hardy to low 20's F



**E**  
*Aloe arborescens (yellow)*  
Native to South Africa  
Shrub to 8 ft.  
Full sun to partial shade  
Hardy to low 20's



**H**  
*Arctostaphylos 'Ruth Bancroft'*  
Hybrid with California parentage  
Shrub to 7 ft. high  
Full sun  
Hardy to the teens F

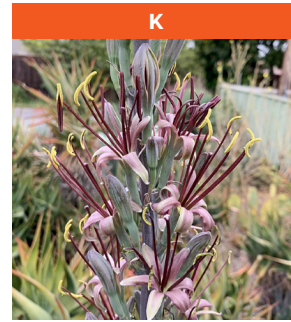

**K**  
*\*Mangave "Inkblot"*  
Hybrid with Mexican parentage  
Stemless rosettes to 1½ft. Ø  
Full sun to partial shade  
Hardy to 25° F



**N**  
*Agave potatorum*  
Native to southern Mexico  
Stemless rosette to 2½ft. Ø  
Full sun to partial sun  
Hardy to 27° F



**C**  
*Garrya elliptica 'James Roof'*  
CA native  
Shrub to 12 ft. tall  
Full sun to partial shade  
Hardy to 10° F



**F**  
*Eriocephalus africanus*  
Native to South Africa  
Shrub to 3 ft.  
Full sun to partial shade  
Hardy to 25° F



**I**  
*Banksia ashbyi*  
Native to Western Australia  
Shrub to 12 ft. tall  
Full sun  
Hardy to 22° F

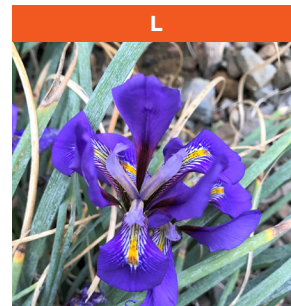

**L**  
*Iris unguicularis*  
Native to Mediterranean  
Clumper to 1 ft. tall  
Full sun to partial sun  
Hardy to below 20° F

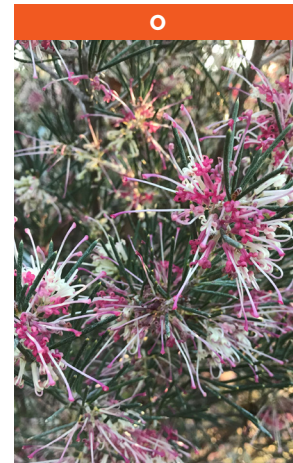

**O**  
*Hakea verrucosa*  
Native to Western Australia  
Shrub to 10 ft. tall  
Full sun  
Hardy to 27° F

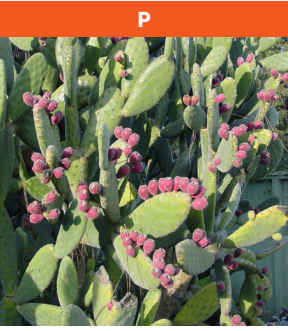

**P**  
*Opuntia tomentosa* (fruit)

Tree-like prickly pear  
Native to Mexico  
Full sun  
Hardy to mid-20's F



**S**  
*Aloe 'G.W. Miller'*

Hybrid with parents from Sudan & Socotra  
Clumper with heads to 7 in. Ø  
Partial shade  
Hardy to upper 20's F



**Q**  
*Chamelaucium 'Matilda'*

Hybrid with Australian parentage  
Shrub to 3 ft. tall  
Full sun  
Hardy to 27° F



**T**  
*Eucalyptus alboburpurea*

Native to southern Australia  
Small tree to 25-30' tall  
Full sun  
Hardy to 20° F

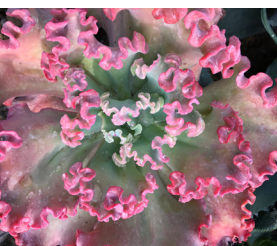

**R**  
*Echeveria 'Lace'*

Hybrid with Mexican parentage  
Single with short stem; heads 1 ft Ø  
Partial shade  
Hardy to 30° F

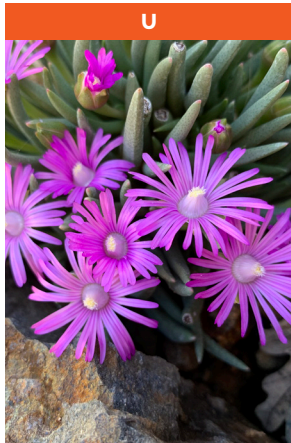

**U**  
*Marlothistella stenophylla*

Native to South Africa  
Clumping ground cover  
Full sun  
Hardy to 25° F

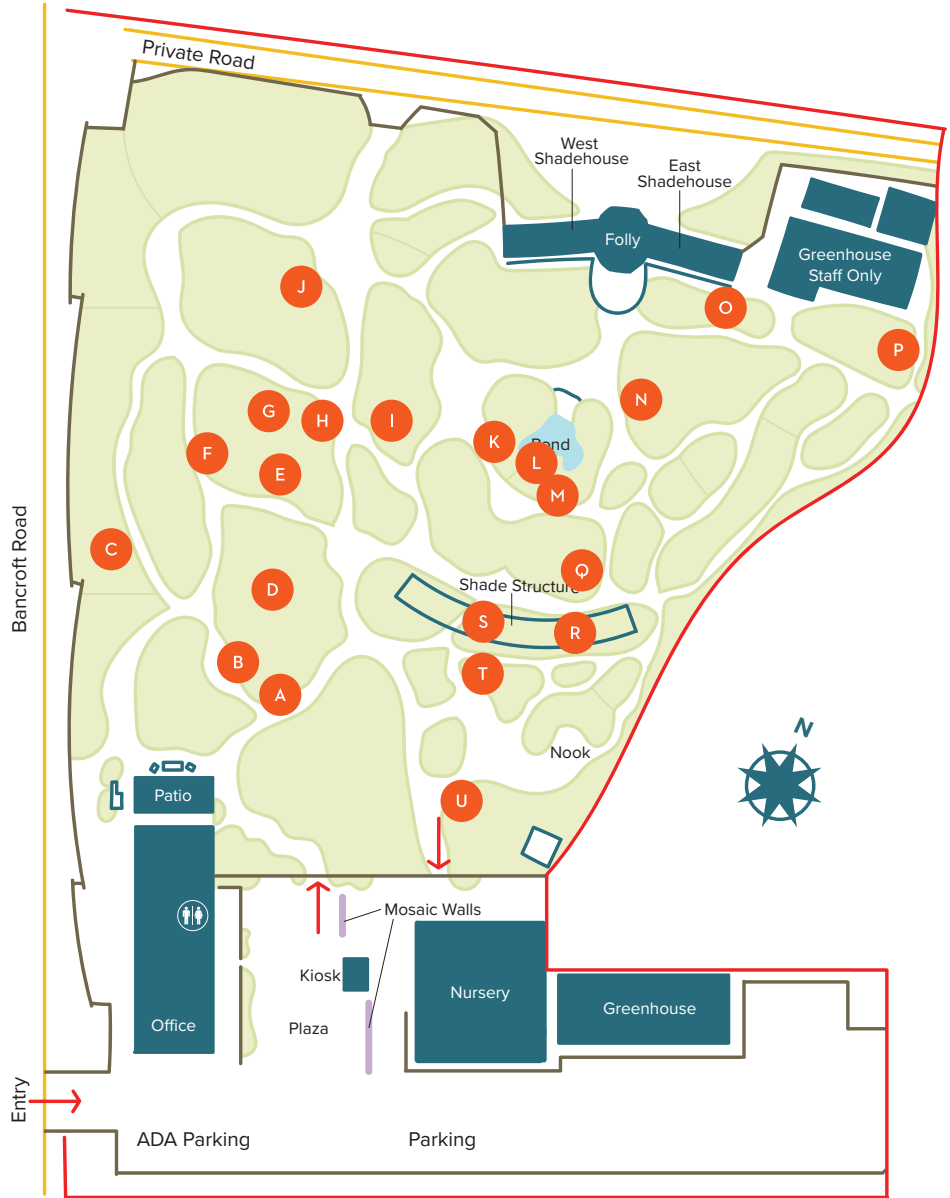

WHAT'S IN BLOOM  
Information Key



This plant or a similar variety is available for purchase in our nursery



indicates diameter