



A
Anigozanthos 'Amber Velvet'
Kangaroo paw
 Hybrid with Western Australian parentage
 Clumping perennial to 2 ft. tall; flower stalks are taller
 Full sun
 Hardy to 25°F



B
Coreopsis gigantea
 Native to California
 Single-trunked or branching, to 5 ft. tall
 Full sun
 Hardy to 25°F



C
Eremophila glabra ssp. carnosa 'Winter Blaze'
 Native to Western Australia
 Shrub, to 3-4 ft. high
 Full sun
 Hardy to 20°F



D
Agave dasylirioides
 Native to Mexico
 Single stemless rosette to 3 ft. Ø
 Full sun to partial shade
 Hardy to 25°F



E
Correa reflexa
 Native to S. & SE Australia
 Shrub to 4 ft. tall
 Full sun to part shade
 Hardy to 25°F



F
Aloe africana
 Native to South Africa
 Single-stemmed to 10 ft. tall
 Full sun to partial shade
 Hardy to 27°F

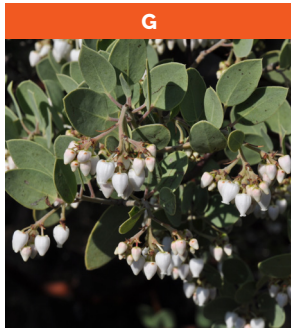

G
Arctostaphylos 'Ruth Bancroft'
 Hybrid with California parentage
 Shrub to 7 ft. high
 Full sun
 Hardy to the teens F

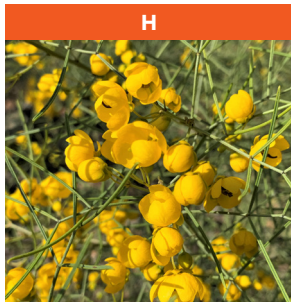

H
Senna artemisioides
 Native to Australia
 Shrub, to 6 ft. high
 Full sun
 Hardy to 15°F

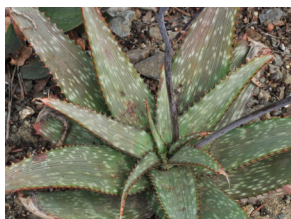

I
Aloe branddraaiensis
 Native to South Africa
 Stemless rosettes to 2 ft. Ø
 Full sun to partial shade
 Hardy to 27°F



J
Euphorbia rigida
 Native to Mediterranean basin
 Perennial to 15 in. tall
 Full sun
 Hardy to below 20°F



K
Aloe 'Creamsicle'
 Hybrid with S. African parentage
 Shrub to 8 ft.
 Full sun to partial shade
 Hardy to 25°F



L
Aloe capitata var. quartzicola
 Native to Madagascar
 Single stemless rosette to 3' Ø
 Full sun
 Hardy to low 20's



M
Puya sp. (Chincheru, Peru)
 Native to the Peruvian highlands
 Clumping; stemless rosettes to 1½ ft. Ø
 Full sun
 Hardy to upper 20's F



N
Aloe microstigma
 Native to South Africa
 Single stemless or short-stemmed rosette to 1½ ft.
 Full sun
 Hardy to low 20's



O
Aloe ferox
 Native to South Africa
 Single rosette to 4 ft. Ø, eventually to 12 ft. tall
 Full sun
 Hardy to mid 20's



Aloe striata

Native to southern South Africa
Single or dividing to form a clump rosettes to 2½ ft.
Full sun
Hardy to mid-20's



Aloe pluridens

Native to South Africa
Clumping, with stems to 10 ft. tall
Full sun to partial shade
Hardy to 25° F



Deuterocohnia brevifolia

(syn. *Abromeitiella brevifolia*)
Native to Argentina & Bolivia
Mound of tiny heads to 3 ft. tall
Sun or part shade
Hardy to 20° F



Senna phyllodinea

Native to Australia
Shrub to 6 ft. tall
Full sun
Hardy to 20°F



Echeveria 'Laulindsa'

Hybrid; parents native to Mexico
Stemless rosette to 1 ft. Ø
Full sun to part shade
Hardy to upper 20's F



Aloe framesii

Native to South Africa
Stemless rosettes to 2 ft. Ø
Full sun
Hardy to 25°F

The Ruth Bancroft Garden and Nursery Map

No Entry
 Restroom Facilities
 Markers
 (Orient yourself in the direction of each arrow)

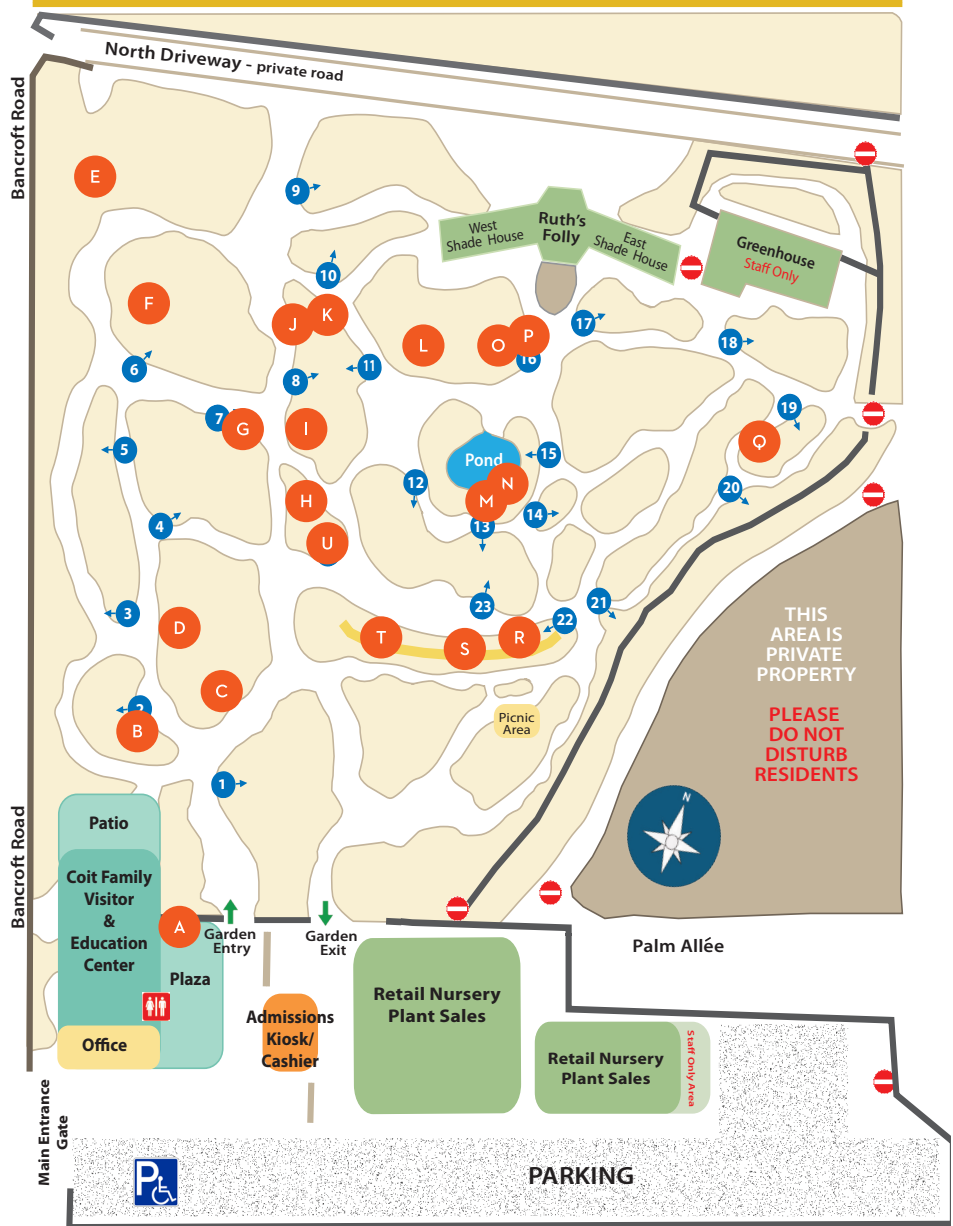

WHAT'S IN BLOOM
Information Key



This plant or a similar variety is available for purchase in our nursery



indicates diameter