



Salvia mojavensis hybrid

Salvia mojavensis hybrid
Hybrid with SW U.S. parentage
Shrub to 4 ft. tall
Full sun
Hardy to low 20's F



Arctostaphylos refugioensis

California native
Shrub to 6 – 13 ft. tall
Full sun to partial shade
Hardy to 8° F



Aloe fosteri

Native to NE South Africa
Stemless rosettes to 3 ft. Ø
Full sun to partial shade
Hardy to mid-20's F



Aloe schelpei

Native to Ethiopia
Stemless clumper; heads to 1½ ft. Ø
Full sun to partial shade
Hardy to low 20's



Russelia equisetiformis

Coral Fountain;
Firecracker Plant
Native to Mexico
Shrub to 4 – 5 ft.
Full sun to partial shade
Hardy to 25° F



Aloe rubroviolacea

Native to Yemen & Saudi Arabia
Clumping; heads to 3 ft. Ø
Full sun
Hardy to low 20's



Ruschia marianae

Native to western S. Africa
Small shrublet
Full sun
Hardy to mid-20's



Crassula sarcocaulis

Native to SE Africa
Shrub to 3 ft. high
Full sun to partial shade
Hardy to 20° F



Echeveria lilacina hybrid

Stemless rosette to 1 ft. Ø
Hybrid of 2 Mexican species
Full sun to partial shade
Hardy to mid-20's



Aloe cheranganiensis

Native to Kenya
Shrub to 3 – 4 ft. tall
Full sun to partial shade
Hardy to 28° F



Aloe arborescens

Native to South Africa
Shrub to 8 ft.
Full sun to partial shade
Hardy to low 20's



Aloe 'Tangerine'

Hybrid; parents native to South Africa
Multi-stemmed, to 8 ft. tall
Sun to part shade
Hardy to 24° F

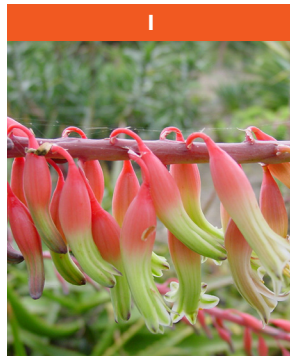

Gasteria acinacifolia

Native to South Africa
Clump-forming & stemless with rosettes to 2½' Ø
Filtered sun
Hardy to 20° F



***Mangave 'Blue Fountain'**

Hybrid with Mexican parentage
Stemless rosette to 3½ ft. Ø
Full sun to partial shade
Hardy to mid 20's F

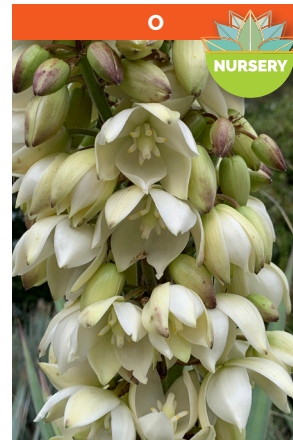

Yucca sp.

Origin unknown (probably Mexico)
Multi-stemmed, to 7 ft. tall
Full sun to partial shade
Hardy to 20° F





P
Agave striata
Native to Mexico
Clumping, with heads to 2 ft. Ø
Full sun to partial shade
Hardy to 20° F



S
Echeveria gigantea
Native to Mexico
Stem-forming, single; to 2 ft. tall
Partial shade
Hardy to upper 20's

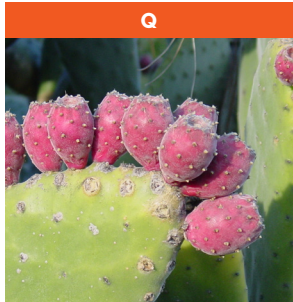

Q
Opuntia tomentosa
Tree-like prickly pear
Native to Mexico
Full sun
Hardy to mid-20's



T
Bulbine latifolia
Native to South Africa
Stemless clumper
Part shade to full sun
Hardy to mid-20's



R
Echeveria 'Lace'
Hybrid with Mexican parentage
Stemless rosette to 2½ft. Ø
Full sun to partial shade
Hardy to 25° F



U
Aloe 'GW Miller'
Hybrid with parents from Sudan & Socotra
Clumper with heads to 7 in. Ø
Partial shade
Hardy to upper 20's F

The Ruth Bancroft Garden and Nursery Map

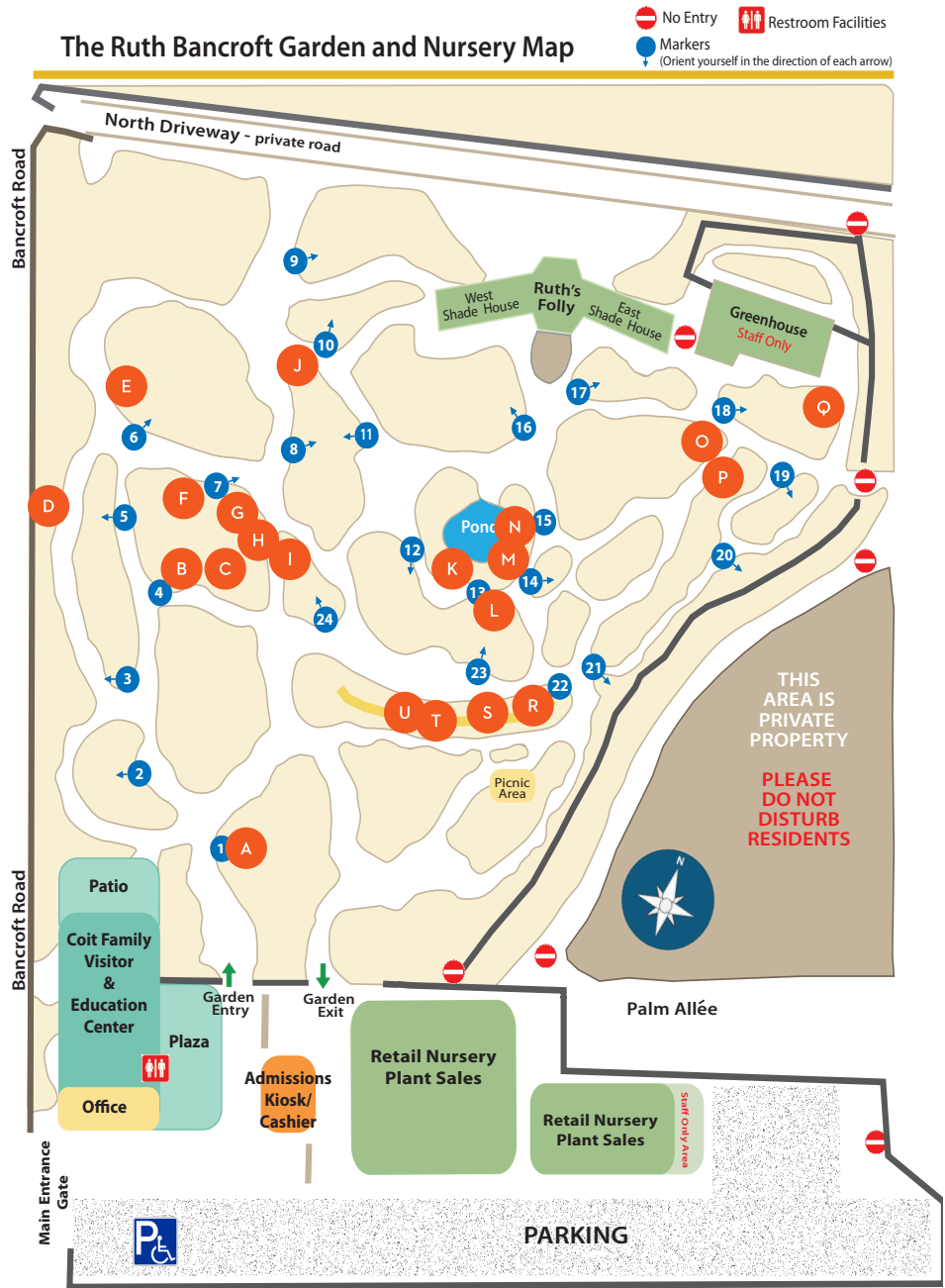

Information Key



This plant or a similar variety is available for purchase in our Nursery.



indicates diameter



Scan the QR code to join the Curator for a virtual version of the "What's in Bloom".