

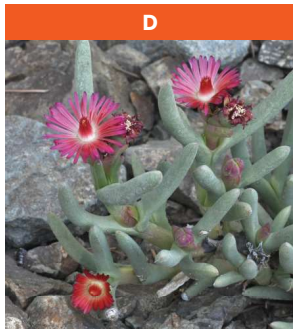

A
Agave dasyliroides
Native to Mexico
Single stemless rosette to 3 ft. Ø
Full sun to partial shade
Hardy to 25° F



D
Ruschia marianae
Native to western S. Africa
Small shrublet
Full sun
Hardy to mid-20's



G
Agave potatorum
Native to southern Mexico
Stemless rosette to 2½ft. Ø
Full sun to partial sun
Hardy to 27° F



J
Aloe reitzii hybrid
Hybrid with South African parentage
Stemless rosette to 8 in. Ø
Full sun to partial shade
Hardy to mid-20's F



M
Echeveria 'Laulindsa'
Hybrid; parents native to Mexico
Stemless rosette to 1 ft. Ø
Full sun to part shade
Hardy to upper 20's F



B
Aloe arborescens
Native to South Africa
Shrub to 8 ft.
Full sun to partial shade
Hardy to low 20's



E
Aloe 'Tangerine'
Hybrid; parents native to S. Africa
Multistemmed, to 8 ft. tall
Sun to part shade
Hardy to 24° F



H
Gasteria acinacifolia
Native to South Africa
Clump-forming & stemless with rosettes to 2½' Ø
Filtered sun
Hardy to 20° F

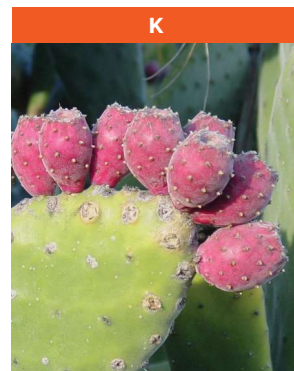

K
Opuntia tomentosa (fruit)
Tree-like prickly pear
Native to Mexico
Full sun
Hardy to mid-20's



N
Aloe hardyi x rubroviolacea
Hybrid; parents from S. Africa & Arabia
Clumper with rosettes 3 ft. Ø
Full sun to partial shade
Hardy to 28° F



C
Aloe rubroviolacea
Native to Yemen & Saudi Arabia
Clumping; heads to 3 ft. Ø
Full sun
Hardy to low 20's



F
Aloe fosteri
Native to NE S. Africa
Stemless rosettes to 3 ft. Ø
Full sun to partial shade
Hardy to mid-20's F



I
Puya sp. (Chincheru, Peru)
Native to the Peruvian highlands
Clumping; stemless rosettes to 1½ ft. Ø
Full sun
Hardy to upper 20's F



L
Opuntia gomei 'Old Mexico' (fruit)
Native to S. Texas & NE Mexico
Shrubby prickly-pear to 4-5 ft. tall
Full sun to partial shade
Hardy to low teens F



O
Bulbine latifolia
Native to South Africa
Stemless clumper
Part shade to full sun
Hardy to mid-20's



P
Crassula sarcocaulis
Native to SE Africa
Shrub to 3 ft. high
Full sun to partial shade
Hardy to 20° F

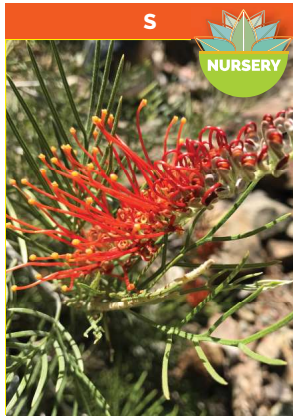

S
Grevillea 'Kings Fire'
Hybrid; parents from Australia
Shrub to 5-6 ft. tall
Full sun
Hardy to 25° F



Q
Aloe zubb x squarrosa
Hybrid; parents from Sudan and Socotra
Clumping; rosettes to 6 in.
Partial shade
Hardy to 30° F



T
Aloe suprafoliata
Native to South Africa
Stemless rosette to 2.5 ft. Ø
Full sun
Hardy to 25°



R
Aloe humilis x pictifolia
Hybrid; parents from S. Africa
Dwarf clumper to 4 in. tall
Full sun to partial sun
Hardy to 27° F

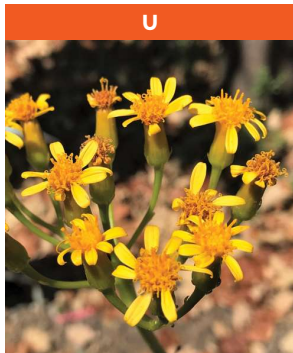

U
Senecio decaryi
Native to Madagascar
Shrub to 3 ft. tall
Full sun to partial shade
Hardy to 27° F

The Ruth Bancroft Garden and Nursery Map

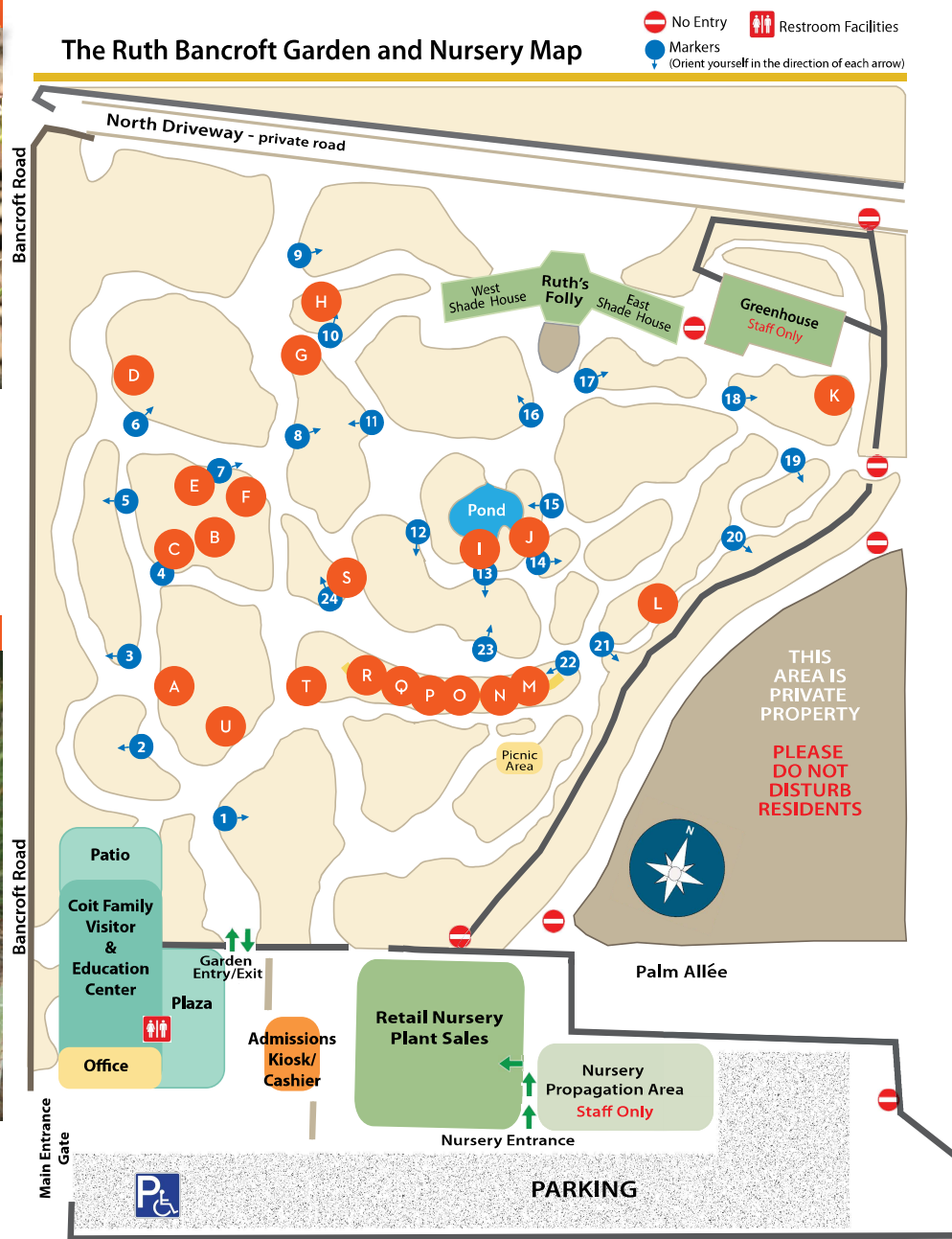

WHAT'S IN BLOOM
Information Key



This plant or a similar variety is available for purchase in our nursery



Ø indicates diameter