

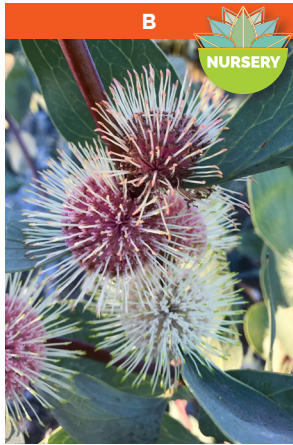

Lachenalia punctata

Native to South Africa
Bulb to 10 in. tall (in flower)
Full sun
Hardy to low 20's F



Hakea petiolaris

Native to Western Australia
Upright shrub to 10 – 16 ft. tall
Full sun
Hardy to low 20's F



Aloe arborescens

Native to South Africa
Shrub to 8 ft.
Full sun to partial shade
Hardy to low 20's



Aloe rubroviolacea

Native to Yemen & Saudi Arabia
Clumping; heads to 3 ft. Ø
Full sun
Hardy to low 20's



Arctostaphylos refugioensis

California native
Shrub to 6 ft. or more
Full sun to partial shade
Hardy to 20° F



Ruschia dichroa

Native to western S. Africa
Small shrublet
Full sun
Hardy to mid-20's



Aloe 'Tangerine'

Hybrid; parents native to S. Africa
Multi-stemmed, to 8 ft. tall
Sun to part shade
Hardy to 24° F

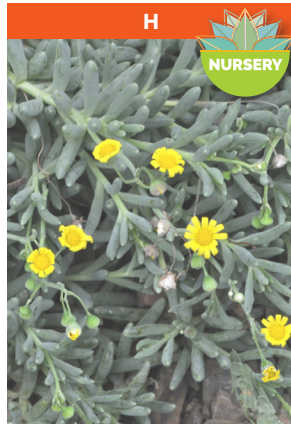

Othonna capensis

Native to SW South Africa
Ground cover
Full sun to part shade
Hardy to low 20's F



Aloe schelpei

Native to Ethiopia
Stemless clumper; heads to 1½ ft. Ø
Full sun to partial shade
Hardy to low 20's

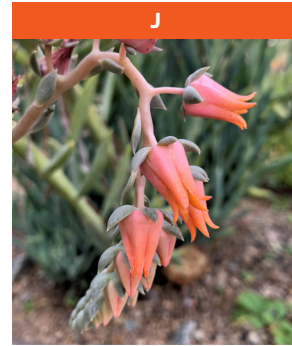

Echeveria lilacina hybrid

Hybrid with Mexican parentage
Stemless rosette to 8" Ø
Partial shade
Hardy to upper 20's F



Aloe cheranganiensis

Native to Kenya
Shrub to 3-4 ft. tall
Full sun to partial shade
Hardy to 28° F



Agave potatorum

Native to southern Mexico
Stemless rosette to 2½ft. Ø
Full sun to partial sun
Hardy to 27° F



Hakea verrucosa

Native to Western Australia
Shrub to 10 ft. tall
Full sun
Hardy to 27° F

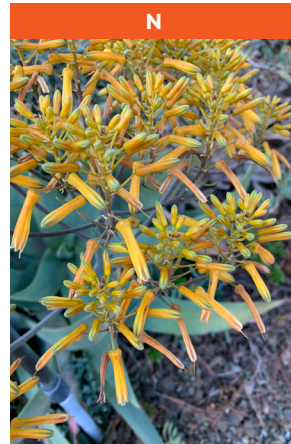

Aloe buhrii hybrid

Hybrid; parents of S. African origin
Rosettes to 3 ft. Ø
Full sun to partial shade
Hardy to mid-20's F



Aloe ellenbeckii

(syn: *Aloe dumetorum*)
Native to Kenya & Somalia
Clumping, with stemless rosettes to 8 in. Ø
Full sun to partial shade
Hardy to 25° F



Echeveria 'Lace'

Hybrid with Mexican parentage
Single with short stem; heads 1 ft Ø
Partial shade
Hardy to 30° F



NURSERY

Aloe vacillans

Native to Arabia
Stemless rosettes to 1½ ft. Ø
Full sun to part shade
Hardy to 25° F



Echeveria gibbiflora

Hybrid; parents from Mexico
Single-headed, to 1½ ft. Ø
Light shade
Hardy to upper 20's



Aloe tororoana

Native to Uganda
Clumping, with short-stemmed rosettes to 1 ft. Ø
Full sun to partial shade
Hardy to upper 20's F



Eucalyptus caesia

Native to Western Australia
Small tree to 20 tall
Full sun
Hardy to low 20's F



Glottiphyllum linguiforme

Forms clump to 1½ ft. Ø
Native to South Africa
Full sun to partial shade
Hardy to upper 20's

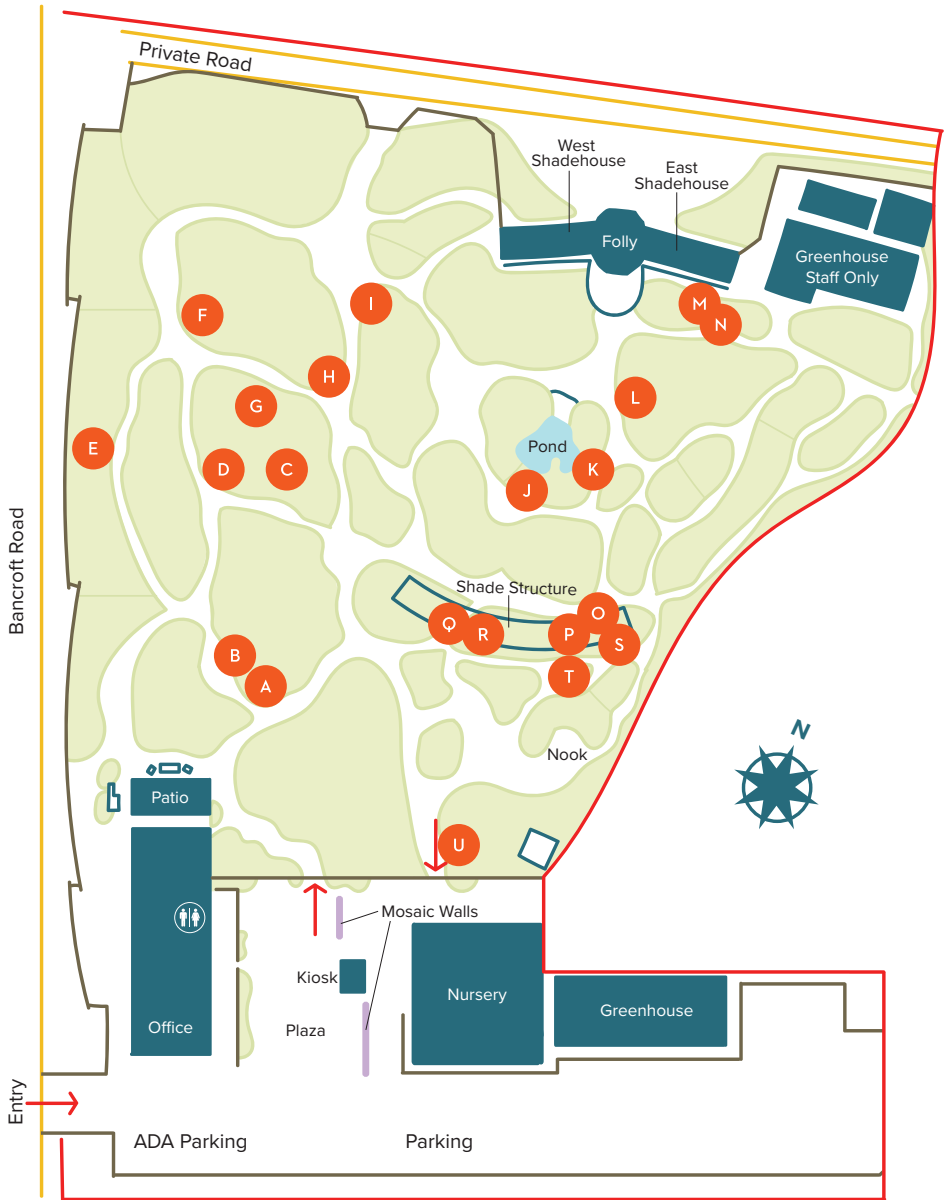

WHAT'S IN BLOOM
Information Key



This plant or a similar variety is available for purchase in our nursery



indicates diameter