



Lotus berthelotii

(Parrot's Beak)

Native to the Canary Islands
Trailing perennial to several feet wide

Full sun to partial shade
Hardy to upper 20's F



Ceanothus cv.

Hybrid with California parentage
Shrub to 4 ft. tall
Full sun to partial shade
Hardy to 20° F



Bulbine frutescens 'Hallmark'

Native to South Africa
Clump to 1½ ft. tall
Full sun to partial shade
Hardy to 20° F



Grevillea lavandulacea 'Penola'

Native to SE Australia
Shrub to 4-5 ft. tall
Full sun
Hardy to 20° F



Aloe buhrii hybrid

Hybrid; parents of S. African origin
Rosettes to 3 ft. Ø
Full sun to partial shade
Hardy to mid-20's F



Ferraria crispa

Native to South Africa
Summer-dormant corm, to 1½ ft. tall
Full sun to partial shade
Hardy to low 20's F



Agave parrasana x colorata

Hybrid with Mexican parentage
Stemless rosette to 2½ ft. Ø
Full sun to partial shade
Hardy to low 20's F



Aloe spicata

Native to South Africa
Solitary or clumping; rosettes to 4 ft. Ø
Full sun to partial shade
Hardy to 27° F



Gasteria bicolor var. liliputana

Native to South Africa
Dwarf clumper to 4 in. tall (without flower stalk)
Partial shade
Hardy to 25° F



Yucca treculeana

Native to Texas & northern Mexico
Multi-stemmed, to 25' tall
Full sun to partial shade
Hardy to 10° F

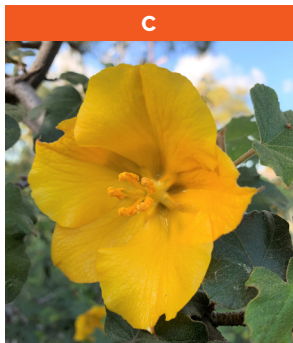

Fremontodendron 'California Glory'

Hybrid; parents from CA & Baja CA
Large shrub to 20 ft. tall
Full sun
Hardy to below 20° F



Grevillea petrophiloides 'Big Bird'

Native to western Australia
Shrub to 5' high; flower stalks to 8'
Full sun
Hardy to 25° F



Philotheca myoporoides

Native to Australia
Shrub to 5 ft. tall
Partial shade
Hardy to 15° F



Euphorbia caput-medusae

Native to South Africa
Stemless cluster of radiating cylindrical "arms"
Full sun to partial shade
Hardy to 20° F

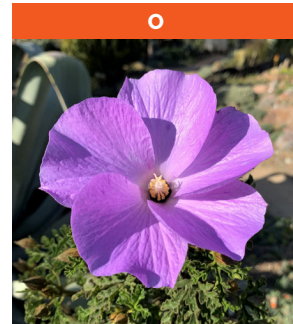

Alyogyne huegelii

(Blue Hibiscus)
Native to Australia
Shrub to 8 – 10 ft. tall
Full sun
Hardy to 25° F



Aloe aculeata x excelsa

Natural hybrid from Zimbabwe
Solitary rosette to 5 feet Ø
Full sun to partial shade
Hardy to upper 20's F



Pelargonium echinatum

Native to South Africa
Small shrub to 8 in. tall
Full sun
Hardy to 25° F



Aloe excelsa x petricola

Hybrid; parents native to South Africa & Zimbabwe
Short-stem single rosette to 5 ft. Ø
Full sun to partial shade
Hardy to upper 20's F



Rhus ovata

Native to CA, AZ, Baja CA
Shrub to 10 ft. tall
Sun or shade
Hardy to 10° F



Euphorbia bupleurifolia

Native to South Africa
Small succulent to 1 ft. tall
Full sun to partial shade
Hardy to 25° F



Isopogon divergens

Native to Western Australia
Shrub to 6 ft. tall
Full sun to partial shade
Hardy to mid-20's F

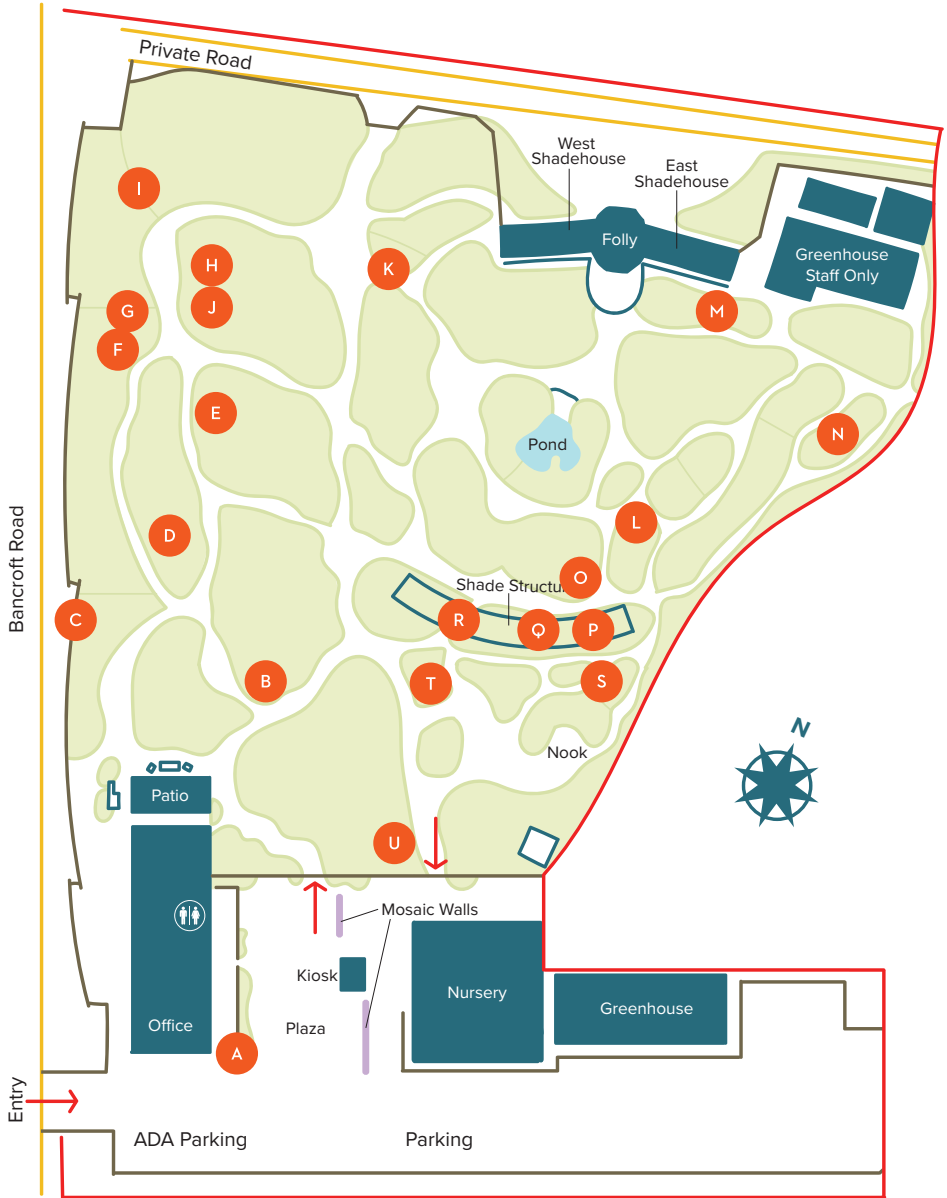

WHAT'S IN BLOOM
Information Key



This plant or a similar variety is available for purchase in the Nursery.



This plant was hybridized by Brian Kemble (Curator).



Indicates diameter.