

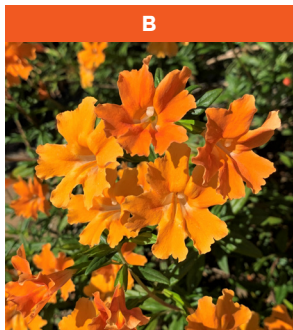

Anigozanthos 'Amber Velvet'

Hybrid with Western Australian parentage
Clumping perennial to 2 ft. tall; flower stalks are taller
Full sun
Hardy to 25° F



Diplacus aurantiacus

(*Mimulus aurantiacus*)
Sticky Monkey Flower
California native
Shrub to 3 - 4 ft. tall
Full sun to partial shade
Hardy to 15° F



Echium candicans

(*Echium fastuosum*)
Native to Madeira (Portuguese island west of Morocco)
Shrub to 6 ft. tall
Full sun
Hardy to mid-20's F



Dudleya brittonii

Native to Baja California
Stemless rosette to 1 ft. θ
Full sun to partial shade
Hardy to 20° F



Sphaeralcea ambigua 'Louis Hamilton'

Native to SW U.S. and NW Mexico
Shrub to 3 ft. tall
Full Sun
Hardy to 15° F



Grevillea petrophiloides 'Big Bird'

Native to western Australia
Shrub to 5' high; flower stalks to 8'
Full sun
Hardy to 25° F

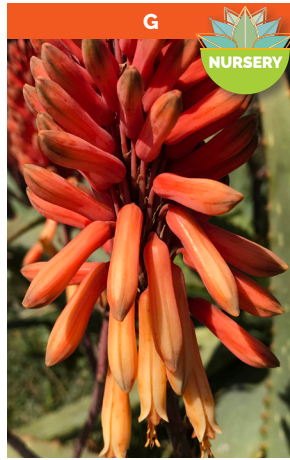

Aloe camperi 'Cornuta'

Native to Ethiopia
Clumping; to 4 ft. tall
Full sun to partial shade
Hardy to 25° F



Lampranthus roseus

Native to South Africa
Shrub up to 5 ft.
Cylindrical lvs. to 1" long
Full sun
Hardy to low 20's



Leucospermum 'Blanche Ito'

Hybrid with South African parentage
Shrub to 5 ft. tall
Full sun
Hardy to 25° F



Gasteria bicolor

Native to southern South Africa
Forms compact clump
Shade or filtered sun
Hardy to low 20's

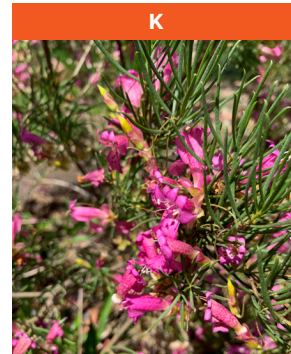

Eremophila alternifolia

Native to S. & W. Australia
Shrub to 10 ft. tall
Full sun to partial shade
Hardy to mid-20's F

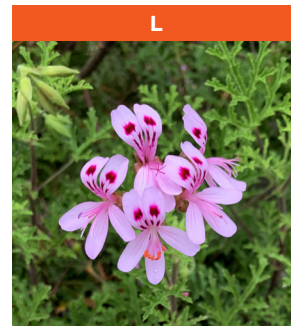

Pelargonium hybrid

(*Scented Geranium*)
Native to South Africa
Shrub to 4 ft. tall
Full sun
Hardy to 25° F



Aloe buhrii hybrid

Hybrid; parents of S. African origin
Rosettes to 3 ft. θ
Full sun to partial shade
Hardy to mid-20's F

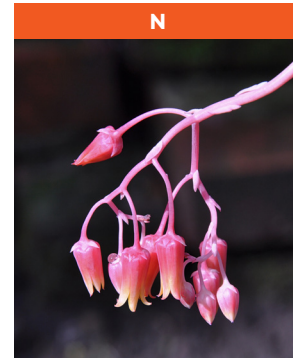

Echeveria colorata

Native to Mexico
Clumping, with stemless rosettes to 8 in. θ
Full sun to partial shade
Hardy to 25° F



Aloe claviflora

Native to South Africa
Stemless clumper; rosettes to 1 ft. θ
Full sun
Hardy to 20° F



P



Alyogyne huegelii
'Santa Cruz'

(Blue Hibiscus)
Native to Australia
Shrub to 8 – 10 ft. tall
Full sun
Hardy to 25° F

S



Aloe hardyi x rubroviolacea

Hybrid; parents from S. Africa & Arabia
Clumper with rosettes 3 ft. Ø
Full sun to partial shade
Hardy to 28° F

Q



Aloe plicatilis

Native to South Africa
Well-branched shrub or small tree to 10 ft.
Full sun to part shade
Hardy to upper 20's

T



Pelargonium echinatum

Native to South Africa
Small shrub to 8 in. tall
Full sun
Hardy to 25° F

R



Aloe harlana

Native to Ethiopia
Stemless rosette to 2 ft. Ø
Full sun to partial shade
Hardy to 27° F

U



Rhus ovata

Native to CA, Arizona, Baja CA
Shrub to 10 ft. tall
Sun or shade
Hardy to 10° F

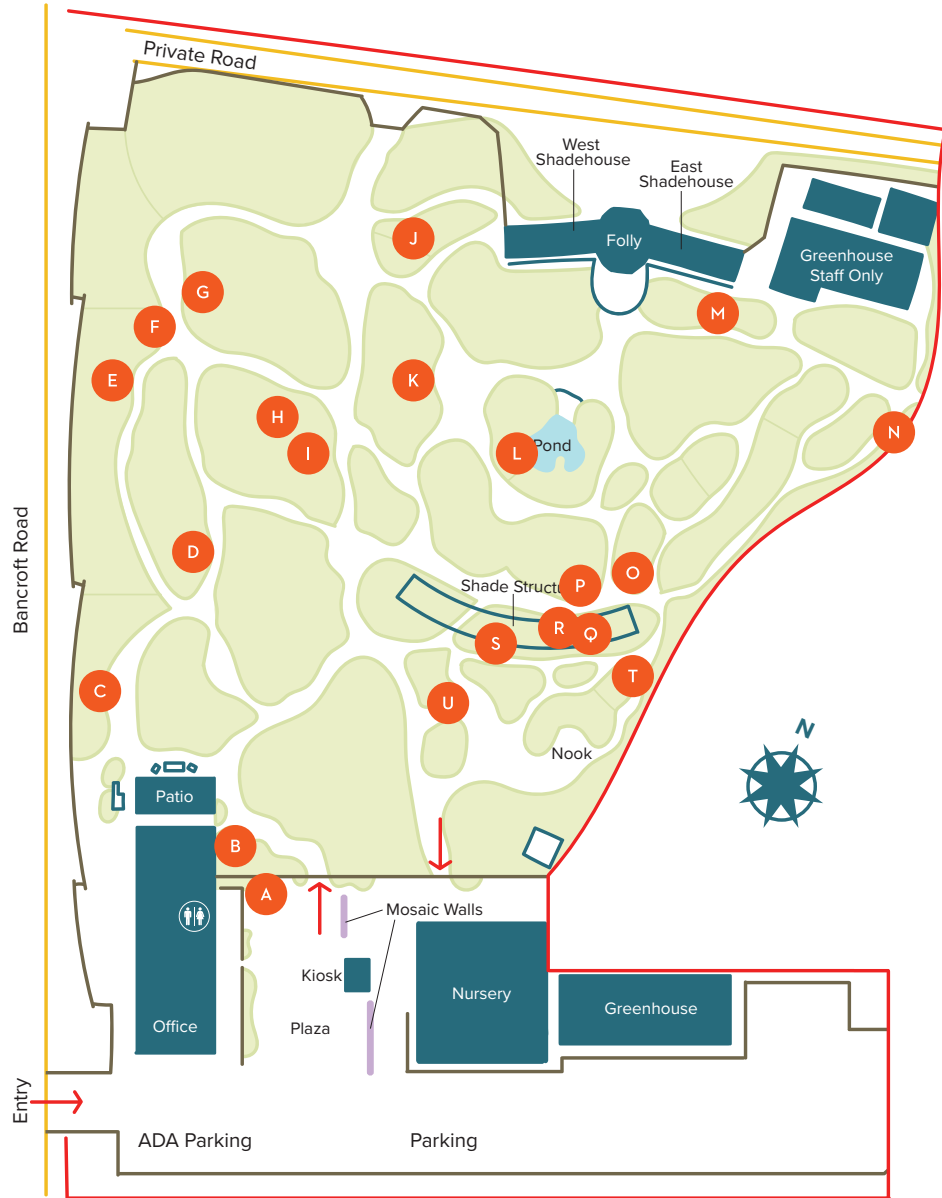

WHAT'S IN BLOOM
Information Key



This plant or a similar variety is available for purchase in our nursery



indicates diameter

Join the Curator for a virtual "What's in Bloom" tour!

