



A



Baileya multiradiata

Native to SW U.S.A. & Mexico
Perennial to 2 ft. tall
Full sun
Hardy to 10° F

D



Aloe affinis

Native to South Africa
Stemless rosettes to 2 ft. Ø
Full sun
Hardy to 25° F

G



Grevillea petrophiloides 'Big Bird'

Native to western Australia
Shrub to 5' high; flower stalks to 8'
Full sun
Hardy to 25° F

J



Agave ghiesbreghtii

Native to southern Mexico
Clumping; rosettes to 3 ft. Ø
Full sun to partial shade
Hardy to mid-twenties F

M



Russelia equisetiformis

Coral Fountain;
Firecracker Plant
Native to Mexico
Shrub to 4 – 5 ft.
Full sun to partial shade
Hardy to 25° F

B



Trichostema 'Midnight Magic'

Hybrid; parents from California & Mexico
Shrub to 4 ft. tall
Full sun to light shade
Hardy to 25° F

E



Aloe speciosa

Native to southern South Africa
Single or branching slowly develops trunk of up to 12 ft
Full sun
Hardy to upper 20's

H

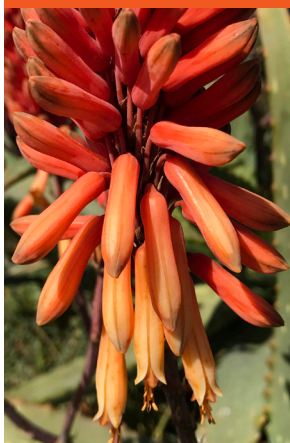

Aloe camperi 'Cornuta'

Native to Ethiopia
Clumping; to 4 ft. tall
Full sun to partial shade
Hardy to 25° F

K



Aloe rupestris

Native to South Africa
Single or multi-trunked, to 20 ft. tall
Full sun to partial shade
Hardy to 25° F

N



Aloe striata

Native to southern South Africa
Single or dividing to form a clump rosettes to 2½ ft.
Full sun
Hardy to mid-20's

C



Lobelia laxiflora

Native to Arizona & Mexico
Perennial to 3 ft. tall
Full sun to partial shade
Hardy to low teens

F



Justicia 'Tecate Gold'

CA & AZ native
Shrub to 5 ft.
Full sun
Hardy to low 20's F

I



Grevillea lavandulacea 'Penola'

Native to SE Australia
Shrub to 4-5 ft. tall
Full sun
Hardy to 20° F

L



Pelargonium hybrid (lemon-scented)

Native to South Africa
Shrub to 4 ft. tall
Full sun
Hardy to 25° F

O



Polygala virgata

Native to South Africa
Shrub to 6 ft.
Full sun to partial shade
Hardy to 20° F



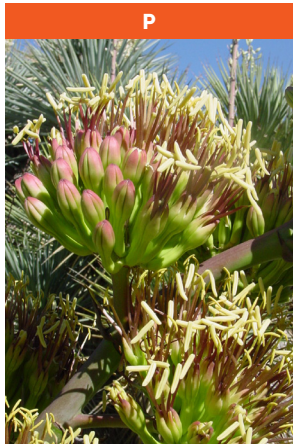

Agave colorata

Native to northwestern Mexico
Rosettes to 2 ft. Ø
Full sun to partial shade
Hardy to mid-20's F



Aloe plicatilis

Native to South Africa
Well-branched shrub or small tree to 10 ft.
Full sun to part shade
Hardy to upper 20's



Aloe claviflora

Native to South Africa
Stemless clumper; rosettes to 1 ft. Ø
Full sun
Hardy to 20° F



Grevillea 'Kings Fire'

Hybrid; parents from Australia
Shrub to 5-6 ft. tall
Full sun
Hardy to 25° F



Bulbine sp. (Tanqua Karoo)

Native to South Africa
Herbaceous tuft to 2 ft. tall
Full sun
Hardy to low 20's F



Yucca treculeana

Native to Texas & northern Mexico
Multi-stemmed, to 25' tall
Full sun to partial shade
Hardy to 10° F

The Ruth Bancroft Garden and Nursery Map

No Entry
 Restroom Facilities
 Markers
 (Orient yourself in the direction of each arrow)

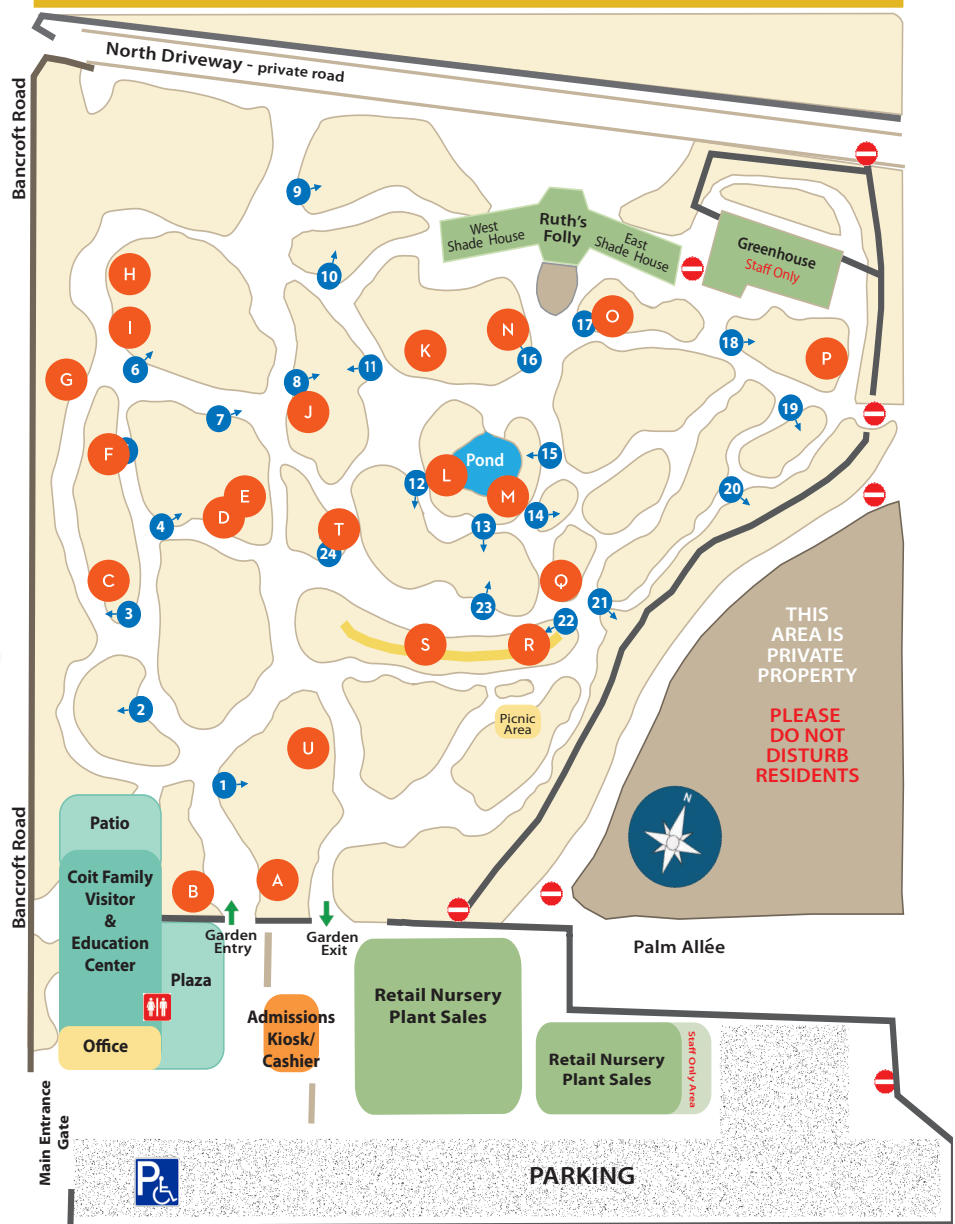

WHAT'S IN BLOOM
Information Key



This plant or a similar variety is available for purchase in our nursery



indicates diameter